

1



Socket & Wrench





6 & 12 Points Socket

1/4 Inch Drive Socket	006
3/8 Inch Drive Socket	007
1/2 Inch Drive Socket	010
3/4 Inch Drive Socket	012

Low Profile Socket 012

Super Lock Socket 013

Spline Socket 017

Star Socket

Star Socket	019
Star Socket Set	021

Universal Joint Socket 022

Universal Joint Socket Set 023

Drive Handle Tools

Ratchet Handle	024
T-Handle	026
Flexible Handle	027
Sliding T-Bar	028
L-Shape Handle	028
Speeder Handle	028

Socket Accessories

Extension Bar	029
Adaptor	034
Universal Joint	035

American Style Socket Set

1/4 Inch Drive Socket Set	036
3/8 Inch Drive Socket Set	039
1/2 Inch Drive Socket Set	042

European Style Socket Set 046

Bits Socket

Star Bit Socket	056
Tamperproof Bit Socket	057
Slotted Bit Socket	058
Phillips Bit Socket	058
Pozi Bit Socket	059
Hex Bit Socket	059
Triple Square Bit Socket	060
5 Point Tamperproof Bit Socket	061
5 Point Star Bit Socket	061
Hex Bit Socket Set	062
Star Bit Socket Set	063

Box Wrench 064

6 & 12 POINTS SOCKET

1/4" DRIVE SOCKET

AMERICAN STANDARD 1/4"DR. SOCKET

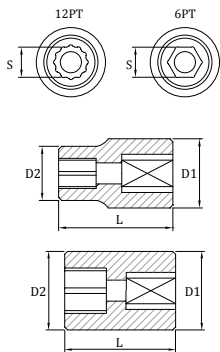

6	12	S	L(mm)	D1(mm)	D2(mm)	G
DCR26104	DCR27104	1/8"	25	12.0	5.5	8
DCR26105	DCR27105	5/32"	25	12.0	6.5	10
DCR26106	DCR27106	3/16"	25	12.0	7.5	10
DCR26107	DCR27107	7/32"	25	12.0	8.5	10
DCR26108	DCR27108	1/4"	25	12.0	9.5	10
DCR26109	DCR27109	9/32"	25	12.0	10.5	11
DCR26110	DCR27110	5/16"	25	12.0	12.0	12
DCR26111	DCR27111	11/32"	25	13.0	13.0	15
DCR26112	DCR27112	3/8"	25	14.5	14.5	16
DCR26114	DCR27114	7/16"	25	16.0	16.0	22
DCR26115	DCR27115	15/32"	25	17.0	17.0	25
DCR26116	DCR27116	1/2"	25	18.0	18.0	32
DCR26118	DCR27118	9/16"	25	20.0	20.0	35

6	12	S	L(mm)	D1(mm)	D2(mm)	G
DCR26204	DCR27204	4	25	12	6.5	10
DCR262045	DCR272045	4.5	25	12	7.2	10
DCR26205	DCR27205	5	25	12	8.0	10
DCR262055	DCR272055	5.5	25	12	8.5	11
DCR26206	DCR27206	6	25	12	9.0	11
DCR26207	DCR27207	7	25	12	10.5	11
DCR26208	DCR27208	8	25	12	12.0	12
DCR26209	DCR27209	9	25	13	13.0	14
DCR26210	DCR27210	10	25	14	14.0	17
DCR26211	DCR27211	11	25	15	15.0	23
DCR26212	DCR27212	12	25	16	16.0	26
DCR26213	DCR27213	13	25	17	17.0	28
DCR26214	DCR27214	14	25	19	19.0	36

AMERICAN STANDARD 1/4"DR. DEEP SOCKET

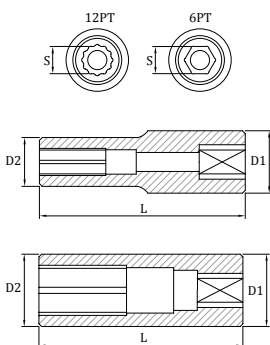

6	12	S	L(mm)	D1(mm)	D2(mm)	G
DLCR26105	DLCR27105	5/32"	50	12.0	6.5	20
DLCR26106	DLCR27106	3/16"	50	12.0	8.5	19
DLCR26107	DLCR27107	7/32"	50	12.0	8.5	19
DLCR26108	DLCR27108	1/4"	50	12.0	9.5	19
DLCR26109	DLCR27109	9/32"	50	12.0	10.5	23
DLCR26110	DLCR27110	5/16"	50	12.0	12.0	23
DLCR26111	DLCR27111	11/32"	50	13.0	13.0	31
DLCR26112	DLCR27112	3/8"	50	14.5	14.5	39
DLCR26114	DLCR27114	7/16"	50	16.0	16.0	42
DLCR26115	DLCR27115	15/32"	50	17.0	17.0	50
DLCR26116	DLCR27116	1/2"	50	18.0	18.0	53
DLCR26118	DLCR27118	9/16"	50	19.0	19.0	50

6	12	S	L(mm)	D1(mm)	D2(mm)	G
DLCR26204	DLCR27204	4	50	12.0	6.8	16
DLCR262045	DLCR272045	4.5	50	12.0	7.4	20
DLCR26205	DLCR27205	5	50	12.0	8.0	19
DLCR262055	DLCR272055	5.5	50	12.0	8.5	19
DLCR26206	DLCR27206	6	50	12.0	9.0	20
DLCR26207	DLCR27207	7	50	12.0	10.5	22
DLCR26208	DLCR27208	8	50	12.0	12.0	25
DLCR26209	DLCR27209	9	50	13.2	13.2	30
DLCR26210	DLCR27210	10	50	14.9	14.7	37
DLCR26211	DLCR27211	11	50	16.0	16.0	43
DLCR26212	DLCR27212	12	50	17.0	17.0	48
DLCR26213	DLCR27213	13	50	18.0	18.0	52
DLCR26214	DLCR27214	14	50	19.0	19.0	68

EUROPEAN STANDARD 1/4"DR. SOCKET

6 **12** 1/4"

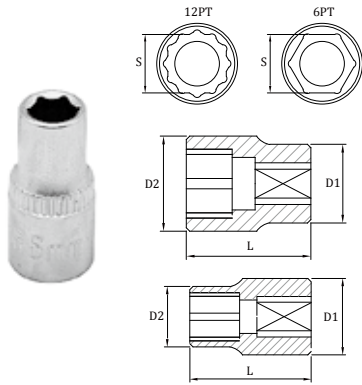

6	12	S	L(mm)	D1(mm)	D2(mm)	G
DRO26204	DRO27204	4.0	25	12.0	6.5	10
DRO262045	DRO272045	4.5	25	12.0	7.2	10
DRO26205	DRO27205	5.0	25	12.0	8.0	10
DRO262055	DRO272055	5.5	25	12.0	8.5	11
DRO26206	DRO27206	6.0	25	12.0	9.0	11
DRO26207	DRO27207	7.0	25	12.0	10.5	11
DRO26208	DRO27208	8.0	25	11.3	11.8	11
DRO26209	DRO27209	9.0	25	12.3	12.9	12
DRO26210	DRO27210	10.0	25	13.3	14.4	14
DRO26211	DRO27211	11.0	25	14.8	15.9	19
DRO26212	DRO27212	12.0	25	15.8	16.9	22
DRO26213	DRO27213	13.0	25	16.8	17.9	24
DRO26214	DRO27214	14.0	25	17.8	19.9	32

EUROPEAN STANDARD 1/4"DR. DEEP SOCKET

6 **12** 1/4"

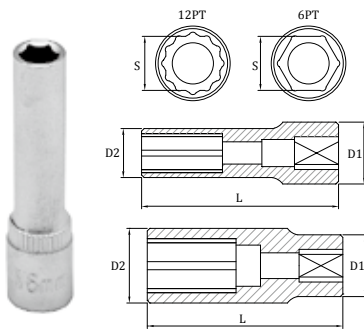

6	12	S	L(mm)	D1(mm)	D2(mm)	G
DLRO26204	DLRO27204	4.0	50	12.0	6.5	16
DLRO262045	DLRO272045	4.5	50	12.0	7.2	20
DLRO26205	DLRO27205	5.0	50	12.0	8.0	19
DLRO262055	DLRO272055	5.5	50	12.0	8.5	19
DLRO26206	DLRO27206	6.0	50	12.0	9.0	20
DLRO26207	DLRO27207	7.0	50	12.0	10.5	22
DLRO26208	DLRO27208	8.0	50	11.3	12.0	24
DLRO26209	DLRO27209	9.0	50	12.0	13.2	24
DLRO26210	DLRO27210	10.0	50	12.7	14.7	37
DLRO26211	DLRO27211	11.0	50	14.0	16.0	43
DLRO26212	DLRO27212	12.0	50	15.0	17.0	47
DLRO26213	DLRO27213	13.0	50	16.0	18.0	52
DLRO26214	DLRO27214	14.0	50	18.0	20.0	54

3/8" DRIVE SOCKET

AMERICAN STANDARD 3/8"DR. SOCKET

6 **12** 3/8"

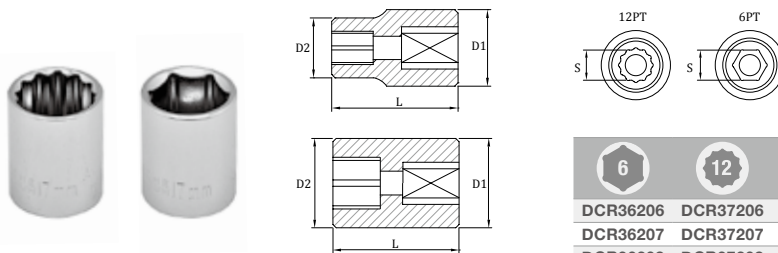

6	12	S	L(mm)	D1(mm)	D2(mm)	G
DCR36108	DCR37108	1/4"	28	16.95	9.5	22
DCR36110	DCR37110	5/16"	28	16.95	11.8	20
DCR36112	DCR37112	3/8"	28	16.95	13.8	21
DCR36114	DCR37114	7/16"	28	16.95	15.8	23
DCR36116	DCR37116	1/2"	28	19.0	19.0	32
DCR36118	DCR37118	9/16"	28	19.78	19.78	34
DCR36120	DCR37120	5/8"	28	21.78	21.78	42
DCR36122	DCR37122	11/16"	30	24.0	24.0	56
DCR36124	DCR37124	3/4"	30	26.0	26.0	66
DCR36126	DCR37126	13/16"	32	28.0	28.0	83
DCR36128	DCR37128	7/8"	32	30.0	30.0	95
DCR36130	DCR37130	15/16"	32	32.0	32.0	102
DCR36132	DCR37132	1"	32	34.0	34.0	130

6	12	S	L(mm)	D1(mm)	D2(mm)	G
DCR36206	DCR37206	6	28	17.0	9.5	19
DCR36207	DCR37207	7	28	17.0	10.7	19
DCR36208	DCR37208	8	28	17.0	11.9	20
DCR36209	DCR37209	9	28	17.0	13.3	21
DCR36210	DCR37210	10	28	17.0	14.3	21
DCR36211	DCR37211	11	28	17.0	15.7	21
DCR36212	DCR37212	12	28	17.9	17.9	27
DCR36213	DCR37213	13	28	19.0	19.0	31
DCR36214	DCR37214	14	28	19.8	19.8	34
DCR36215	DCR37215	15	28	21.0	21.0	39
DCR36216	DCR37216	16	28	24.0	24.0	42
DCR36217	DCR37217	17	30	25.0	25.0	59
DCR36218	DCR37218	18	30	25.0	25.0	63
DCR36219	DCR37219	19	30	26.0	26.0	67
DCR36220	DCR37220	20	32	28.0	28.0	83
DCR36221	DCR37221	21	32	28.0	28.0	73
DCR36222	DCR37222	22	32	30.0	30.0	90
DCR36223	DCR37223	23	32	31.0	31.0	110
DCR36224	DCR37224	24	32	32.0	32.0	108

Socket & Wrench

Impact Socket

Air Chisels

Automotive Tools

6 & 12 POINTS SOCKET

AMERICAN STANDARD 3/8"DR. SEMI-DEEP SOCKET

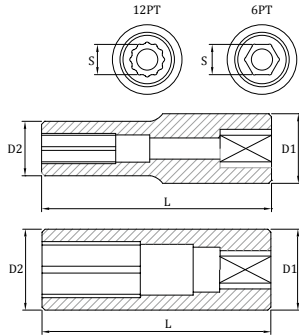

6	12	S	L(mm)	D1(mm)	D2(mm)	G
DLCR36110	DLCR37110	5/16"	46	17	11.8	51
DLCR36112	DLCR37112	3/8"	46	17	13.8	51
DLCR36114	DLCR37114	7/16"	46	17	15.8	53
DLCR36116	DLCR37116	1/2"	46	19	19.0	75
DLCR36118	DLCR37118	9/16"	46	20	20.0	76

6	12	S	L(mm)	D1(mm)	D2(mm)	G
DLCR36208	DLCR37208	8	46	16.85	11.90	45
DLCR36209	DLCR37209	9	46	16.85	13.3	51
DLCR36210	DLCR37210	10	46	16.85	14.30	53
DLCR36211	DLCR37211	11	46	16.85	15.7	53
DLCR36212	DLCR37212	12	46	17.85	17.85	67
DLCR36213	DLCR37213	13	46	18.85	18.85	73
DLCR36214	DLCR37214	14	46	19.85	19.85	78

AMERICAN STANDARD 3/8"DR. DEEP SOCKET

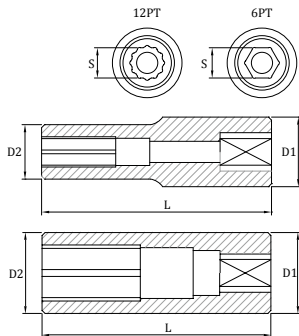

6	12	S	L(mm)	D1(mm)	D2(mm)	G
DLCR36108	DLCR37108	1/4"	63.0	17.0	9.5	60
DLCR36109	DLCR37109	9/32"	63.0	17.0	10.8	60
DLCR36110	DLCR37110	5/16"	63.0	17.0	11.8	51
DLCR36112	DLCR37112	3/8"	63.0	17.0	13.8	51
DLCR36114	DLCR37114	7/16"	63.0	17.0	15.8	53
DLCR36116	DLCR37116	1/2"	63.0	19.0	19.0	75
DLCR36118	DLCR37118	9/16"	63.0	20.0	20.0	76
DLCR36120	DLCR37120	5/8"	63.0	22.2	22.2	96
DLCR36122	DLCR37122	11/16"	63.0	24.0	24.0	116
DLCR36124	DLCR37124	3/4"	63.0	26.0	26.0	134
DLCR36126	DLCR37126	13/16"	63.0	28.0	28.0	153
DLCR36128	DLCR37128	7/8"	63.0	30.0	30.0	193
DLCR36130	DLCR37130	15/16"	63.0	32.0	32.0	225

6	12	S	L(mm)	D1(mm)	D2(mm)	G
DLCR36206	DLCR37206	6	63.0	16.85	9.50	44
DLCR36207	DLCR37207	7	63.0	16.85	10.7	50
DLCR36208	DLCR37208	8	63.0	16.85	11.9	45
DLCR36209	DLCR37209	9	63.0	16.85	13.3	51
DLCR36210	DLCR37210	10	63.0	16.85	14.3	53
DLCR36211	DLCR37211	11	63.0	16.85	15.7	53
DLCR36212	DLCR37212	12	63.0	17.85	17.85	67
DLCR36213	DLCR37213	13	63.0	18.85	18.85	73
DLCR36214	DLCR37214	14	63.0	19.85	19.85	78
DLCR36215	DLCR37215	15	63.0	21.0	21.0	84
DLCR36216	DLCR37216	16	63.0	22.20	22.2	98
DLCR36217	DLCR37217	17	63.0	24.0	24.0	118
DLCR36218	DLCR37218	18	63.0	25.0	25.0	126
DLCR36219	DLCR37219	19	63.0	26.0	26.0	136
DLCR36220	DLCR37220	20	63.0	27.85	27.85	137
DLCR36221	DLCR37221	21	63.0	27.85	27.85	136
DLCR36222	DLCR37222	22	63.0	30.0	30.0	144
DLCR36223	DLCR37223	23	63.0	30.0	30.0	180
DLCR26224	DLCR26224	24	63.0	32.0	32.0	180

EUROPEAN STANDARD 3/8"DR. SOCKET

6 **12** **3/8"**

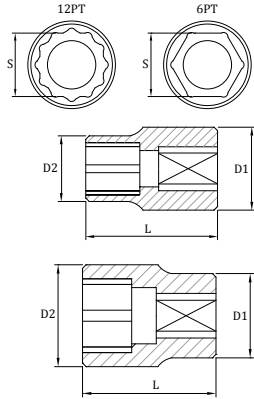

6	12	S	L(mm)	D1(mm)	D2(mm)	G
DRO36206	DRO37206	6	28	17.0	9.5	19
DRO36207	DRO37207	7	28	17.0	10.7	19
DRO36208	DRO37208	8	28	17.0	11.9	20
DRO36209	DRO37209	9	28	17.0	13.3	21
DRO36210	DRO37210	10	28	17.0	14.3	21
DRO36211	DRO37211	11	28	17.0	15.7	21
DRO36212	DRO37212	12	28	16.3	17.0	24
DRO36213	DRO37213	13	28	17.0	18.0	29
DRO36214	DRO37214	14	28	19.0	19.5	32
DRO36215	DRO37215	15	28	20.0	21.0	36
DRO36216	DRO37216	16	28	21.0	22.0	39
DRO36217	DRO37217	17	30	22.0	23.5	53
DRO36218	DRO37218	18	30	23.0	24.5	57
DRO36219	DRO37219	19	30	24.0	26.0	61
DRO36220	DRO37220	20	32	25.0	28.0	74
DRO36221	DRO37221	21	32	26.0	28.0	74
DRO36222	DRO37222	22	32	28.0	30.0	88
DRO36223	DRO37223	23	32	29.0	32.0	98
DRO36224	DRO37224	24	32	30.0	32.0	98

Socket & Wrench

Impact Socket

Air Chisels

EUROPEAN STANDARD 3/8"DR. DEEP SOCKET

6 **12** **3/8"**

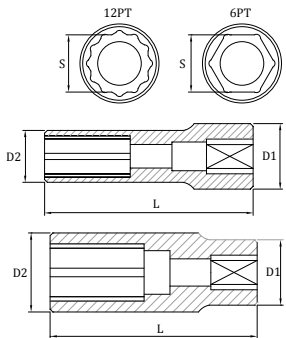

6	12	S	L(mm)	D1(mm)	D2(mm)	G
DLRO36206	DLRO37206	6	63	17.0	9.6	44
DLRO36207	DLRO37207	7	63	17.0	10.7	50
DLRO36208	DLRO37208	8	63	17.0	11.9	45
DLRO36209	DLRO37209	9	63	17.0	13.3	51
DLRO36210	DLRO37210	10	63	17.0	14.3	53
DLRO36211	DLRO37211	11	63	17.0	15.7	53
DLRO36212	DLRO37212	12	63	16.3	17.0	59
DLRO36213	DLRO37213	13	63	17.0	18.0	68
DLRO36214	DLRO37214	14	63	18.8	19.5	74
DLRO36215	DLRO37215	15	63	19.8	20.9	77
DLRO36216	DLRO37216	16	63	20.8	21.9	89
DLRO36217	DLRO37217	17	63	22.0	23.4	110
DLRO36218	DLRO37218	18	63	22.0	24.4	119
DLRO36219	DLRO37219	19	63	23.8	25.9	122
DLRO36220	DLRO37220	20	63	24.8	26.9	156
DLRO36221	DLRO37221	21	63	25.8	27.9	146
DLRO36222	DLRO37222	22	63	27.8	29.9	173
DLRO36223	DLRO37223	23	63	28.5	31.0	185
DLRO36224	DLRO37224	24	63	29.5	32.0	185

Automotive Tools

6 & 12 POINTS SOCKET

1/2" DRIVE SOCKET

AMERICAN STANDARD 1/2"DR. SOCKET

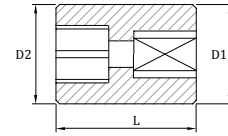
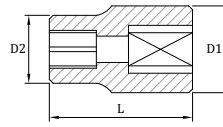
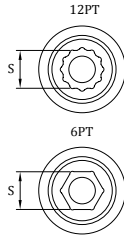

6	12	S	L(mm)	D1(mm)	D2(mm)	G
DCR46112	DCR47112	3/8"	38	22.2	14.9	48
DCR46114	DCR47114	7/16"	38	22.2	16.8	50
DCR46116	DCR47116	1/2"	38	22.2	18.8	53
DCR46118	DCR47118	9/16"	38	22.2	20.5	54
DCR46120	DCR47120	5/8"	38	22.2	22.2	55
DCR46122	DCR47122	11/16"	38	24.2	24.2	68
DCR46124	DCR47124	3/4"	38	27.0	27.0	89
DCR46126	DCR47126	13/16"	38	28.0	28.0	92
DCR46128	DCR47128	7/8"	38	30.0	30.0	111
DCR46130	DCR47130	15/16"	38	32.0	32.0	124
DCR46132	DCR47132	1"	42	34.0	34.0	157
DCR46134	DCR47134	1-1/16"	42	36.0	36.0	186
DCR46136	DCR47136	1-1/8"	42	38.0	38.0	210
DCR46138	DCR47138	1-3/16"	42	40.0	40.0	226
DCR46140	DCR47140	1-1/4"	42	42.0	42.0	266

6	12	S	L(mm)	D1(mm)	D2(mm)	G
DCR46208	DCR47208	8	38	22.2	12.7	50
DCR46209	DCR47209	9	38	22.2	14.3	50
DCR46210	DCR47210	10	38	22.2	15.4	48
DCR46211	DCR47211	11	38	22.2	16.6	49
DCR46212	DCR47212	12	38	22.2	18.0	51
DCR46213	DCR47213	13	38	22.2	19.1	52
DCR46214	DCR47214	14	38	22.2	20.2	54
DCR46215	DCR47215	15	38	22.2	21.3	56
DCR46216	DCR47216	16	38	22.2	22.2	54
DCR46217	DCR47217	17	38	24.2	24.2	67
DCR46218	DCR47218	18	38	25.0	25.0	75
DCR46219	DCR47219	19	38	27.0	27.0	90
DCR46220	DCR47220	20	38	27.85	27.85	98
DCR46221	DCR47221	21	38	27.85	27.85	91
DCR46222	DCR47222	22	38	29.85	29.85	112
DCR46223	DCR47223	23	38	31.0	31.0	119
DCR46224	DCR47224	24	38	32.0	32.0	128
DCR46225	DCR47225	25	42	33.0	33.0	167
DCR46226	DCR47226	26	42	35.0	35.0	193
DCR46227	DCR47227	27	42	36.0	36.0	183
DCR46228	DCR47228	28	42	38.0	38.0	220
DCR46229	DCR47229	29	42	39.0	39.0	225
DCR46230	DCR47230	30	42	40.0	40.0	237
DCR46231	DCR47231	31	32	41.0	41.0	220
DCR46232	DCR47232	32	42	42.0	42.0	266

AMERICAN STANDARD 1/2"DR. DEEP SOCKET

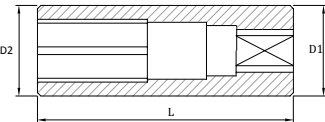
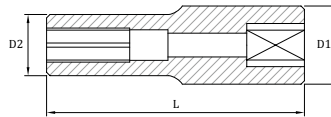
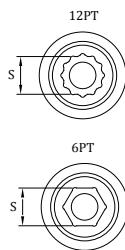

6	12	S	L(mm)	D1(mm)	D2(mm)	G
DLCR46112	DLCR47112	3/8"	76.5	22.2	14.9	99
DLCR46114	DLCR47114	7/16"	76.5	22.2	16.8	99
DLCR46116	DLCR47116	1/2"	76.5	22.2	18.8	107
DLCR46118	DLCR47118	9/16"	76.5	22.2	20.5	108
DLCR46120	DLCR47120	5/8"	76.5	22.2	22.2	104
DLCR46122	DLCR47122	11/16"	76.5	24.0	24.0	125
DLCR46124	DLCR47124	3/4"	76.5	27.0	27.0	175
DLCR46126	DLCR47126	13/16"	76.5	28.0	28.0	177
DLCR46128	DLCR47128	7/8"	76.5	30.0	30.0	212
DLCR46130	DLCR47130	15/16"	76.5	32.0	32.0	236
DLCR46132	DLCR47132	1"	76.5	34.0	34.0	269
DLCR46134	DLCR47134	1-1/16"	76.5	36.0	36.0	306
DLCR46136	DLCR47136	1-1/8"	76.5	38.0	38.0	346
DLCR46138	DLCR47138	1-3/16"	76.5	40.0	40.0	383
DLCR46140	DLCR47140	1-1/4"	76.5	42.0	42.0	401

6	12	S	L(mm)	D1(mm)	D2(mm)	G
DLCR46208	DLCR47208	8	76.5	22.2	12.7	93
DLCR46209	DLCR47209	9	76.5	22.2	14.3	93
DLCR46210	DLCR47210	10	76.5	22.2	15.4	93
DLCR46211	DLCR47211	11	76.5	22.2	16.6	93
DLCR46212	DLCR47212	12	76.5	22.2	18.0	100
DLCR46213	DLCR47213	13	76.5	22.2	19.1	112
DLCR46214	DLCR47214	14	76.5	22.2	20.2	102
DLCR46215	DLCR47215	15	76.5	22.2	21.3	114
DLCR46216	DLCR47216	16	76.5	22.2	22.2	104
DLCR46217	DLCR47217	17	76.5	23.85	23.85	131
DLCR46218	DLCR47218	18	76.5	24.85	24.85	142
DLCR46219	DLCR47219	19	76.5	26.85	26.85	175
DLCR46220	DLCR47220	20	76.5	27.85	27.85	188
DLCR46221	DLCR47221	21	76.5	27.85	27.85	188
DLCR46222	DLCR47222	22	76.5	29.85	29.85	212
DLCR46223	DLCR47223	23	76.5	31.0	31.0	252
DLCR46224	DLCR47224	24	76.5	31.85	31.85	240
DLCR46225	DLCR47225	25	76.5	34.0	34.0	280
DLCR46226	DLCR47226	26	76.5	35.0	35.0	253
DLCR46227	DLCR47227	27	76.5	36.0	36.0	306
DLCR46228	DLCR47228	28	76.5	37.0	37.0	346
DLCR46229	DLCR47229	29	76.5	39.0	39.0	383
DLCR46230	DLCR47230	30	76.5	40.0	40.0	383
DLCR46231	DLCR47231	31	76.5	41.0	41.0	401
DLCR46232	DLCR47232	32	76.5	42.0	42.0	412

EUROPEAN STANDARD 1/2"DR. SOCKET

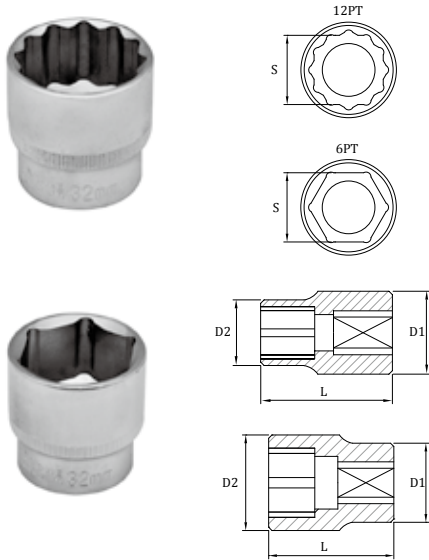

6	12	S	L(mm)	D1(mm)	D2(mm)	G
DRO46208	DRO47208	8	38	22.2	12.4	50
DRO46209	DRO47209	9	38	22.2	14.2	50
DRO46210	DRO47210	10	38	22.2	15.3	50
DRO46211	DRO47211	11	38	22.2	16.5	51
DRO46212	DRO47212	12	38	22.2	17.8	52
DRO46213	DRO47213	13	38	22.2	19.0	52
DRO46214	DRO47214	14	38	22.2	20.2	54
DRO46215	DRO47215	15	38	22.2	21.3	54
DRO46216	DRO47216	16	38	22.2	23.2	60
DRO46217	DRO47217	17	38	23.0	24.2	63
DRO46218	DRO47218	18	38	23.0	25.0	66
DRO46219	DRO47219	19	38	24.0	27.0	80
DRO46220	DRO47220	20	38	24.0	28.0	77
DRO46221	DRO47221	21	38	24.0	29.0	91
DRO46222	DRO47222	22	38	26.0	30.0	92
DRO46223	DRO47223	23	38	28.0	31.0	102
DRO46224	DRO47224	24	38	28.0	32.0	105
DRO46225	DRO47225	25	42	28.0	34.0	139
DRO46226	DRO47226	26	42	29.0	35.0	147
DRO46227	DRO47227	27	42	30.0	36.0	150
DRO46228	DRO47228	28	42	30.0	37.0	175
DRO46229	DRO47229	29	42	31.0	38.0	179
DRO46230	DRO47230	30	42	34.0	40.0	200
DRO46232	DRO47232	32	42	36.0	42.0	219

Socket & Wrench

Impact Socket

Air Chisels

Automotive Tools

EUROPEAN STANDARD 1/2"DR. DEEP SOCKET

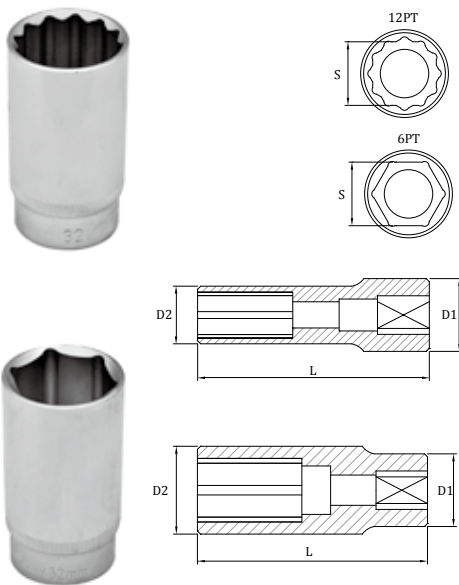

6	12	S	L(mm)	D1(mm)	D2(mm)	G
DLRO46208	DLRO47208	8	76.5	22.2	12.4	70
DLRO46209	DLRO47209	9	76.5	22.2	14.2	70
DLRO46210	DLRO47210	10	76.5	22.2	15.3	73
DLRO46211	DLRO47211	11	76.5	22.2	16.5	80
DLRO46212	DLRO47212	12	76.5	22.2	17.8	90
DLRO46213	DLRO47213	13	76.5	22.2	19.0	96
DLRO46214	DLRO47214	14	76.5	22.2	20.2	100
DLRO46215	DLRO47215	15	76.5	22.2	21.3	110
DLRO46216	DLRO47216	16	76.5	22.0	23.2	114
DLRO46217	DLRO47217	17	76.5	23.0	24.2	126
DLRO46218	DLRO47218	18	76.5	23.5	25.0	131
DLRO46219	DLRO47219	19	76.5	24.0	27.0	161
DLRO46220	DLRO47220	20	76.5	24.0	28.0	167
DLRO46221	DLRO47221	21	76.5	24.0	29.0	192
DLRO46222	DLRO47222	22	76.5	26.0	30.0	192
DLRO46223	DLRO47223	23	76.5	28.0	31.0	213
DLRO46224	DLRO47224	24	76.5	28.0	32.0	214
DLRO46226	DLRO47226	26	76.5	32.0	35.0	280
DLRO46227	DLRO47227	27	76.5	33.0	37.0	310
DLRO46228	DLRO47228	28	76.5	34.0	38.0	330
DLRO46229	DLRO47229	29	76.5	35.0	39.0	355
DLRO46230	DLRO47230	30	76.5	36.0	40.0	355
DLRO46232	DLRO47232	32	76.5	38.0	43.0	408

6 & 12 POINTS SOCKET

3/4" DRIVE SOCKET

3/4"DR. 6PT SOCKET (mm)



3/4"

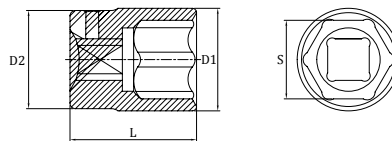

6	S	L(mm)	D1(mm)	D2(mm)
CDDR66219	19	50	29	36
CDDR66221	21	50	31	36
CDDR66222	22	50	32	36
CDDR66224	24	52	34	36
CDDR66227	27	52	38	36
CDDR66228	28	52	38	36
CDDR66230	30	54	42	36
CDDR66232	32	56	44	36
CDDR66233	33	56	46	36
CDDR66234	34	56	46	36
CDDR66236	36	58	50	45
CDDR66238	38	60	52	45
CDDR66241	41	64	56	45
CDDR66246	46	68	62	45
CDDR66250	50	72	68	45
CDDR66255	55	76	74	45
CDDR66260	60	79	80	45

LOW PROFILE SOCKET

3/8"DR. LOW PROFILE SOCKET



3/8"

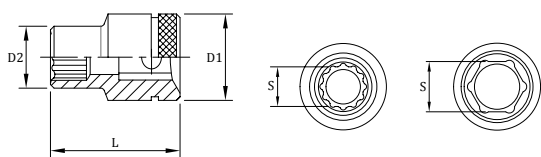

6	12	S	L(mm)	D1(mm)	D2(mm)
DS36208	DS37208	8	17	17	12
DS36209	DS37209	9	17	17	13
DS36210	DS37210	10	18	17	14
DS36211	DS37211	11	18	17	16
DS36212	DS37212	12	18	17	17
DS36213	DS37213	13	19	17	18
DS36214	DS37214	14	19	19	20
DS36215	DS37215	15	19	20	21
DS36216	DS37216	16	20	20	22
DS36217	DS37217	17	20	22	23
DS36218	DS37218	18	21	23	24
DS36219	DS37219	19	21	24	26

SUPER LOCK SOCKET

SUPER LOCK SOCKETS



ABOUT SUPER LOCK SOCKETS

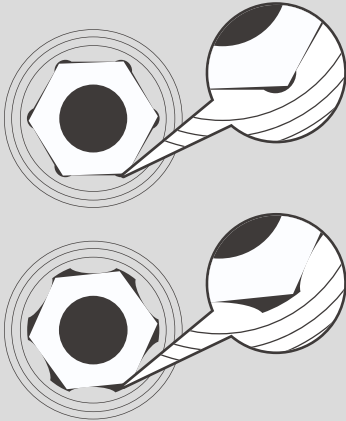

- Wavy internal socket profile enable the torque to be applied completely on the wall of bolt instead of corner. Against the slippage on nut or bolt head.
- Applicable for damaged hexagon bolts.
- More torque efficiency.

1/4"DR. SUPER LOCK SOCKET

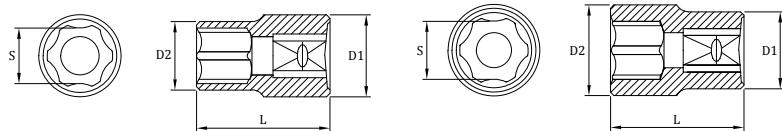

Item No.	S	L(mm)	D1(mm)	D2(mm)
DR26204	4	25	12	6.8
DR262045	4.5	25	12	7.4
DR26205	5	25	12	8.0
DR262055	5.5	25	12	8.6
DR26206	6	25	12	9.2
DR26207	7	25	12	10.5
DR26208	8	25	11.3	13.0
DR26209	9	25	12.0	14.5
DR26210	10	25	12.7	13.0
DR26211	11	25	14.0	17.0
DR26212	12	25	15.0	18.0
DR26213	13	25	16.0	20.0
DR26214	14	25	18.0	20.0

Item No.	S	L(mm)	D1(mm)	D2(mm)
DR26105	5/32"	24.8	12	6.8
DR26106	3/16"	24.8	12	7.7
DR26107	7/32"	24.8	12	8.6
DR26108	1/4"	24.8	12	9.5
DR26109	9/32"	24.8	12	10.7
DR26110	5/16"	24.8	11.3	12.0
DR26111	11/32"	24.8	12.0	13.1
DR26112	3/8"	24.8	12.7	14.0
DR26113	13/32"	24.8	12.7	14.5
DR26114	7/16"	24.8	14.0	16.0
DR26115	15/32"	24.8	15.0	17.0
DR26116	1/2"	24.8	16.0	17.8
DR26214	14	25	18.0	20.0

SUPER LOCK SOCKET

1/4"DR. SUPER LOCK DEEP SOCKET



1/4

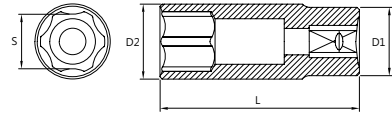
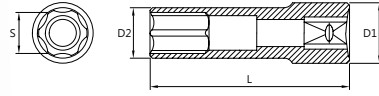

Item No.	S	L(mm)	D1(mm)	D2(mm)
DLR26204	4.0	50	12.0	6.8
DLR262045	4.5	50	12.0	7.4
DLR26205	5.0	50	12.0	8.0
DLR262055	5.5	50	12.0	8.6
DLR26206	6.0	50	12.0	9.2
DLR26207	7.0	50	12.0	10.5
DLR26208	8.0	50	11.3	12.0
DLR26209	9.0	50	12.0	13.2
DLR26210	10.0	50	12.7	14.7
DLR26211	11.0	50	14.0	16.0
DLR26212	12.0	50	15.0	17.0
DLR26213	13.0	50	16.8	18.0
DLR26214	14.0	50	18.0	20.0

Item No.	S	L(mm)	D1(mm)	D2(mm)
DLR26105	5/32"	50	11.85	6.8
DLR26106	3/16"	50	11.85	7.7
DLR26107	7/32"	50	11.85	8.0
DLR26108	1/4"	50	11.85	9.5
DLR26109	9/32"	50	11.85	10.7
DLR26110	5/16"	50	11.85	11.3
DLR26111	11/32"	50	13.20	12.0
DLR26112	3/8"	50	14.70	12.7
DLR26113	13/32"	50	14.70	12.7
DLR26114	7/16"	50	15.85	14.0
DLR26115	15/32"	50	17.00	15.0
DLR26116	1/2"	50	17.85	16.0

3/8"DR. SUPER LOCK SOCKET



3/8"

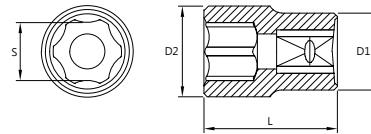
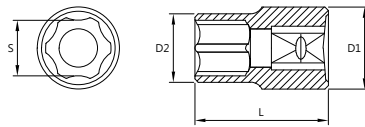

Item No.	S	L(mm)	D1(mm)	D2(mm)
DR36206	6	28	17	10.1
DR36207	7	28	17	10.7
DR36208	8	28	17	11.9
DR36209	9	28	17	13.3
DR36210	10	28	17	14.3
DR36211	11	28	17	15.7
DR36212	12	28	18	17.1
DR36213	13	28	17.3	18.5
DR36214	14	28	18.5	20.0
DR36215	15	28	19.5	21.0
DR36216	16	28	20.5	22.0
DR36217	17	30	22.0	24.0
DR36218	18	32	23.0	25.0
DR36219	19	30	24.0	26.0
DR36220	20	30	25.0	28.0
DR36221	21	32	26.0	28.0
DR36222	22	32	27.5	30.0
DR36223	23	32	28.5	32.0
DR36224	24	32	29.5	32.0

Item No.	S	L(mm)	D1(mm)	D2(mm)
DR36108	1/4"	28	16.95	10.1
DR36110	5/16"	28	16.95	11.8
DR36112	3/8"	28	16.95	13.8
DR36114	7/16"	28	16.95	15.8
DR36116	1/2"	28	17.3	19.00
DR36118	9/16"	28	18.5	19.78
DR36120	5/8"	28	20.5	21.78
DR36122	11/16"	30	22.0	23.96
DR36124	3/4"	30	24.0	25.96
DR36126	13/16"	32	26.0	27.96
DR36128	7/8"	32	27.5	29.96
DR36130	15/16"	32	29.5	31.93



3/8"DR. SUPER LOCK DEEP SOCKET



3/8"

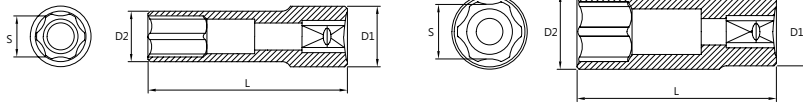

Item No.	S	L(mm)	D1(mm)	D2(mm)
DLR36206	6	63	17.0	10.0
DLR36207	7	63	17.0	10.7
DLR36208	8	63	17.0	12.0
DLR36209	9	63	17.0	13.3
DLR36210	10	63	17.0	14.3
DLR36211	11	63	17.0	15.7
DLR36212	12	63	18.0	17.1
DLR36213	13	63	17.0	19.0
DLR36214	14	63	18.2	20.0
DLR36215	15	63	19.0	22.2
DLR36216	16	63	20.0	24.0
DLR36217	17	63	22.0	25.0
DLR36218	18	63	23.0	26.0
DLR36219	19	63	24.0	28.0
DLR36220	20	63	25.0	28.0
DLR36221	21	63	26.0	30.0
DLR36222	22	63	27.5	32.0
DLR36223	23	63	28.5	32.0
DLR36224	24	63	29.5	32.0

Item No.	S	L(mm)	D1(mm)	D2(mm)
DLR36108	1/4"	63	16.85	10.1
DLR36110	5/16"	63	16.85	11.8
DLR36112	3/8"	63	16.85	13.8
DLR36114	7/16"	63	16.85	15.8
DLR36116	1/2"	63	17.0	18.85
DLR36118	9/16"	63	18.2	19.85
DLR36120	5/8"	63	20.0	22.20
DLR36122	11/16"	63	22.0	23.85
DLR36124	3/4"	63	24.0	25.85
DLR36126	13/16"	63	26.0	27.85
DLR36128	7/8"	63	27.5	29.85
DLR36130	15/16"	63	29.5	32.00

Socket & Wrench

Impact Socket

Air Chisels

Automotive Tools

1/2"DR. SUPER LOCK SOCKET



1/2"

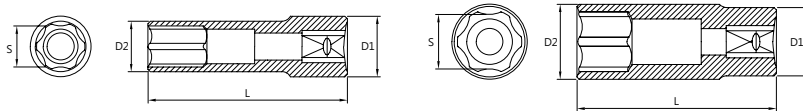

Item No.	S	L(mm)	D1(mm)	D2(mm)
DR46208	8	38	22.3	13.2
DR46209	9	38	22.3	14.3
DR46210	10	38	22.3	15.4
DR46211	11	38	22.3	16.6
DR46212	12	38	22.3	18.0
DR46213	13	38	22.3	19.1
DR46214	14	38	22.3	20.2
DR46215	15	38	21.4	20.8
DR46216	16	38	22.4	23.0
DR46217	17	38	23.4	24.0
DR46218	18	38	24.0	25.0
DR46219	19	38	24.0	27.0
DR46220	20	38	24.0	28.0
DR46221	21	38	26.0	28.0
DR46222	22	38	28.0	30.0
DR46223	23	38	28.0	32.0
DR46224	24	38	28.0	32.0
DR46225	25	42	28.0	34.0
DR46226	26	42	28.0	36.0
DR46227	27	42	30.0	36.0
DR46228	28	42	32.0	38.0
DR46229	29	42	33.0	38.0
DR46230	30	42	34.0	40.0
DR46231	31	42	35.0	42.0
DR46232	32	42	36.0	42.0
DR46236	36	48	40.0	49.5

Item No.	S	L(mm)	D1(mm)	D2(mm)
DR46112	3/8"	38	22.2	14.9
DR46114	7/16"	38	22.2	16.8
DR46116	1/2"	38	22.2	18.8
DR46118	9/16"	38	22.2	20.5
DR46120	5/8"	38	22.0	22.20
DR46122	11/16"	38	23.0	24.20
DR46124	3/4"	38	24.0	27.00
DR46126	13/16"	38	24.0	27.85
DR46128	7/8"	38	26.0	29.85
DR46130	15/16"	38	28.0	31.85
DR46132	1"	42	28.0	34.00
DR46134	1-1/16"	42	30.0	36.00
DR46136	1-1/8"	42	32.0	38.00
DR46138	1-3/16"	42	34.0	40.00
DR46140	1-1/4"	42	36.0	42.00

SUPER LOCK SOCKET

1/2"DR. SUPER LOCK DEEP SOCKET



1/2"

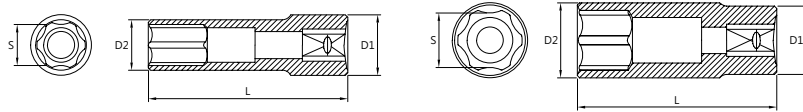

Item No.	S	L(mm)	D1(mm)	D2(mm)
DLR46208	8	76.5	22.2	13.2
DLR46209	9	76.5	22.2	14.3
DLR46210	10	76.5	22.2	15.4
DLR46211	11	76.5	22.2	16.6
DLR46212	12	76.5	22.2	18.0
DLR46213	13	76.5	22.2	19.1
DLR46214	14	76.5	22.2	20.2
DLR46215	15	76.5	22.2	21.3
DLR46216	16	76.5	22.0	23.0
DLR46217	17	76.5	23.0	24.0
DLR46218	18	76.5	23.0	25.0
DLR46219	19	76.5	24.0	27.0
DLR46220	20	76.5	24.0	28.0
DLR46221	21	76.5	24.0	28.0
DLR46222	22	76.5	26.0	30.0
DLR46223	23	76.5	28.0	32.0
DLR46224	24	76.5	28.0	32.0
DLR46225	25	76.5	30.0	34.0
DLR46226	26	76.5	30.0	34.0
DLR46227	27	76.5	32.0	36.0
DLR46228	28	76.5	34.0	38.0
DLR46229	29	76.5	36.0	40.0
DLR46230	30	76.5	36.0	40.0
DLR46231	31	76.5	38.0	42.0
DLR46232	32	76.5	38.0	42.0

Item No.	S	L(mm)	D1(mm)	D2(mm)
DLR46112	3/8"	76.5	22.2	14.9
DLR46114	7/16"	76.5	22.2	16.8
DLR46116	1/2"	76.5	22.2	18.8
DLR46118	9/16"	76.5	22.2	20.5
DLR46120	5/8"	76.5	22.2	22
DLR46122	11/16"	76.5	22.85	22
DLR46124	3/4"	76.5	27.0	24
DLR46126	13/16"	76.5	27.85	24
DLR46128	7/8"	76.5	29.85	26
DLR46130	15/16"	76.5	31.85	28
DLR46132	1"	76.5	32	34
DLR46134	1-1/16"	76.5	33	36
DLR46136	1-1/8"	76.5	34	38
DLR46138	1-3/16"	76.5	36	40
DLR46140	1-1/4"	76.5	38	42

ABOUT SPLINE SOCKET

- Precise, radial spline teeth engage the fastener teeth over a wider area to minimize stress
- Allow application of high torque without damage to the fastener or to the tool.
- On ordinary 6-point and 12-point, as well as square and star fasteners.
- Not military standard spline socket.

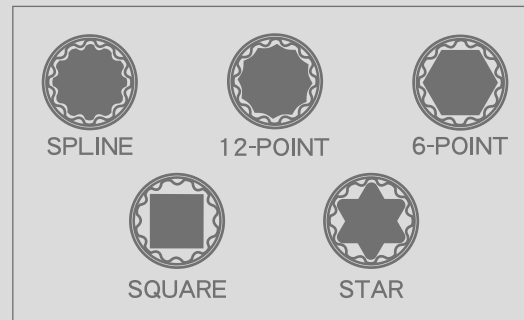

SPLINE SOCKET

1/4"DR. SPLINE SOCKET



1/4"

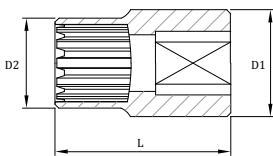
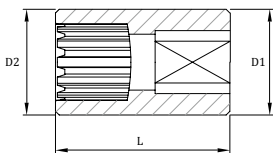
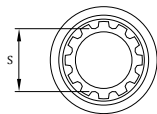

Item No.	S	S(inch)	L(mm)	D1(mm)	D2(mm)	G
QCR29204	4	5/32"	25	12	7.4	11.0
QCR292045	4.5	11/64"	25	12	8.0	11.1
QCR29205	5	3/16"	25	12	8.6	11.1
QCR292055	5.5	7/32"	25	12	9.2	10.9
QCR29206	6	1/4"	25	12	9.8	11.2
QCR29207	7	9/32"	25	12	11.0	11.0
QCR29208	8	5/16"	25	13	13.0	14.7
QCR29209	9	11/32"	25	14	14.0	16.9
QCR29210	10	3/8"	25	16	16.0	22.4
QCR29211	11	7/16"	25	16	16.0	19.8
QCR29212	12	15/32"	25	18	18.0	27.2
QCR29213	13	1/2"	25	19	19.0	28.0
QCR29214	14	9/16"	25	20	20.0	36.0

SPLINE SOCKET

3/8"DR. SPLINE SOCKET



3/8"

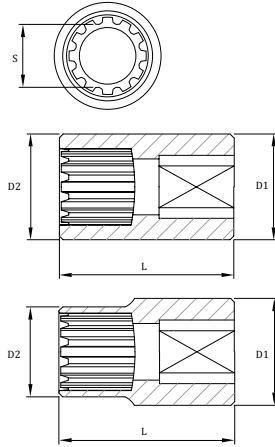

Item No.	S	L(mm)	D1(mm)	D2(mm)	G
QCR39206	6	28	17.0	10.0	23
QCR39207	7	28	17.0	11.5	23
QCR39208	8	28	17.0	12.7	23
QCR39209	9	28	17.0	14.0	24
QCR39210	10	28	17.0	15.5	24
QCR39211	11	28	17.0	17.0	24
QCR39212	12	28	18.5	18.5	29
QCR39213	13	28	20.0	20.0	31
QCR39214	14	28	21.0	21.0	34
QCR39215	15	28	22.0	22.2	45
QCR39216	16	30	23.0	23.0	45
QCR39217	17	30	25.0	24.0	59
QCR39218	18	30	26.0	23.0	59
QCR39219	19	30	27.0	27.0	68
QCR39220	20	30	28.0	28.0	81
QCR39221	21	32	30.0	30.0	81
QCR39222	22	32	31.0	31.0	92
QCR39223	23	32	32.0	32.0	120
QCR39224	24	32	34.0	34.0	120

1/2"DR. SPLINE SOCKET



1/2"

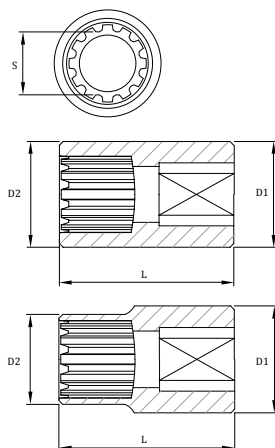

Item No.	S	L(mm)	D1(mm)	D2(mm)	G
QCR49208	8	38	22.2	13.8	50
QCR49209	9	38	22.2	15.0	50
QCR49210	10	38	22.2	16.2	51
QCR49211	11	38	22.2	17.5	51
QCR49212	12	38	22.2	18.7	52
QCR49213	13	38	22.2	20.0	52
QCR49214	14	38	22.2	21.0	52
QCR49215	15	38	23.5	22.2	62
QCR49216	16	38	23.5	22.2	58
QCR49217	17	38	25.0	23.0	67
QCR49218	18	38	26.0	23.5	73
QCR49219	19	38	27.0	24.0	70
QCR49220	20	38	28.0	24.0	66
QCR49221	21	38	30.0	24.0	78
QCR49222	22	38	31.0	26.0	90
QCR49223	23	38	32.0	28.0	100
QCR49224	24	38	34.0	28.0	109
QCR49227	27	42	37.0	30.0	145
QCR49230	30	42	41.0	34.0	182
QCR49232	32	42	44.0	36.0	212

STAR SOCKET

STAR SOCKET

1/4" DR. STAR SOCKET

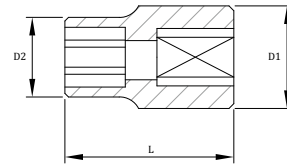
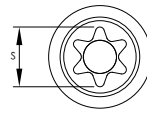

Item No.	S	L(mm)	D1(mm)	D2(mm)	G
ECR26204	E4	25	12.0	6.2	10
ECR26205	E5	25	12.0	7.2	10
ECR26206	E6	25	12.0	8.2	11
ECR26207	E7	25	12.0	9.0	11
ECR26208	E8	25	12.0	10.3	12
ECR26210	E10	25	13.2	12.5	18
ECR26211	E11	25	14.0	13.2	23

3/8" DR. STAR SOCKET

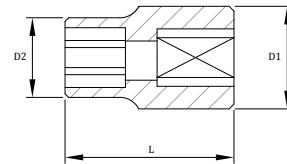
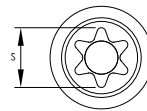

Item No.	S	L(mm)	D1(mm)	D2(mm)	G
ECR36204	E4	28	17	6.2	24
ECR36205	E5	28	17	7.2	24
ECR36206	E6	28	17	8.2	24
ECR36207	E7	28	17	9.0	24
ECR36208	E8	28	17	10.3	23
ECR36210	E10	28	17	13.2	25
ECR36211	E11	28	17	13.8	26
ECR36212	E12	28	17	14.8	26
ECR36214	E14	28	18	16.8	31
ECR36216	E16	28	20	18.8	41
ECR36218	E18	28	22	20.8	51
ECR36220	E20	28	24	22.8	67

1/2" DR. STAR SOCKET

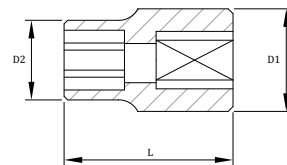
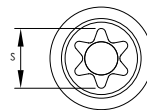

Item No.	S	L(mm)	D1(mm)	D2(mm)	G
ECR46210	E10	38	22	13.2	52
ECR46211	E11	38	22	13.9	52
ECR46212	E12	38	22	15.0	51
ECR46214	E14	38	22	16.8	55
ECR46216	E16	38	22	18.8	57
ECR46218	E18	38	22	20.8	60
ECR46220	E20	38	24	23.0	72
ECR46222	E22	38	26	25.0	90
ECR46224	E24	38	28	27.0	109

Socket & Wrench

Impact Socket

Air Chisels

Automotive Tools

STAR SOCKET

1/4" DR. STAR DEEP SOCKET



1/4"

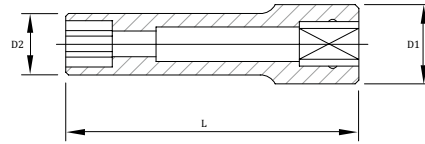
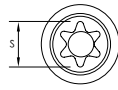

Item No.	S	L(mm)	D1(mm)	D2(mm)	G
ELCR26204	E4	50	12	6.2	16
ELCR26205	E5	50	12	7.2	19
ELCR26206	E6	50	12	8.2	20
ELCR26207	E7	50	12	9.0	22
ELCR26208	E8	50	12	10.3	25
ELCR26210	E10	50	13	12.5	37
ELCR26211	E11	50	14	13.2	43

3/8" DR. STAR DEEP SOCKET



3/8"

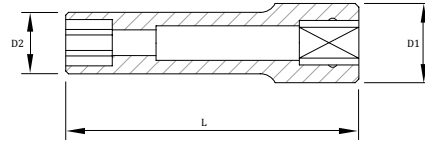
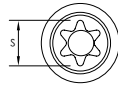

Item No.	S	L(mm)	D1(mm)	D2(mm)	G
ELCR36204	E4	63	17	6.2	29
ELCR36205	E5	63	17	7.2	33
ELCR36206	E6	63	17	8.2	37
ELCR36207	E7	63	17	9.0	39
ELCR36208	E8	63	17	10.3	46
ELCR36210	E10	63	17	13.2	50
ELCR36211	E11	63	17	13.8	54
ELCR36212	E12	63	17	14.8	58
ELCR36214	E14	63	18	16.8	77
ELCR36216	E16	63	20	18.8	89
ELCR36218	E18	63	22	20.8	109
ELCR36220	E20	63	24	22.8	140

1/2" DR. STAR DEEP SOCKET



1/2"

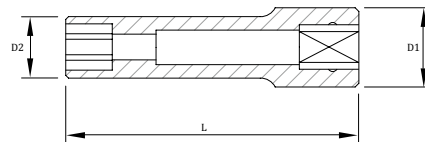
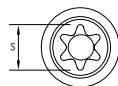

Item No.	S	L(mm)	D1(mm)	D2(mm)	G
ELCR46210	E10	76.5	22	13.2	68
ELCR46211	E11	76.5	22	13.9	74
ELCR46212	E12	76.5	22	15.0	85
ELCR46214	E14	76.5	22	16.8	100
ELCR46216	E16	76.5	22	18.8	116
ELCR46218	E18	76.5	22	20.8	131
ELCR46220	E20	76.5	24	23.0	150
ELCR46222	E22	76.5	26	25.0	179
ELCR46224	E24	76.5	28	27.0	214

STAR SOCKET SET

10PC 1/2"DR. STAR SOCKET SET



Item No.	10PC-10
METAL CASE	L:270 x W:73 x H:46 mm
WEIGHT	1175 (g)

CONTENT	
1/2"DR. STAR SOCKET	E10, E11, E12, E14, E16, E18, E20, E22, E24

*The set number includes the metal case or blow case.

Socket & Wrench

Impact Socket

Air Chisels

Automotive Tools

11PC 1/4" & 3/8"DR. STAR SOCKET SET



Item No.	11PC-06
DOUBLE BLISTER	L:250 x W100 mm
WEIGHT	700 (g)

CONTENT	
1/4"DR. STAR SOCKET	E4, E5, E6, E7, E8
3/8"DR. STAR SOCKET	E10, E12, E14, E16, E18

28PC 1/4" & 3/8" & 1/2"DR. STAR SOCKET SET

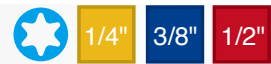

Item No.	28PC-09A2
BLOW CASE	L:256 x W:148 x H:45 mm
WEIGHT	1165 (g)

CONTENT	
1/4"DR. STAR SOCKET	E4, E5, E6, E7, E8, E10, E11
3/8"DR. STAR SOCKET	E4, E5, E6, E7, E8, E10, E11, E12, E14, E16, E18, E20
1/2"DR. STAR SOCKET	E10, E11, E12, E14, E16, E18, E20, E22, E24

UNIVERSAL JOINT SOCKET

UNIVERSAL JOINT SOCKET

1/4"DR. UNIVERSAL JOINT SOCKET

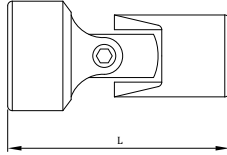
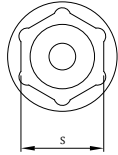

6P Item No.	12P Item No.	S	L(mm)	G
CUK26106	CUK27106	3/16"	35.0	22.0
CUK26108	CUK27108	1/4"	35.0	22.0
CUK26110	CUK27110	5/16"	35.0	23.0
CUK26112	CUK27112	3/8"	37.5	25.5
CUK26114	CUK27114	7/16"	37.5	26.0
CUK26116	CUK27116	1/2"	38.5	30.5
CUK26118	CUK27118	9/16"	38.5	30.5

6P Item No.	12P Item No.	S	L(mm)	G
CUK26205	CUK27205	5	35.0	21.5
CUK262055	CUK272055	5.5	35.0	20.5
CUK26206	CUK27206	6	35.0	21.5
CUK26207	CUK27207	7	35.0	22.0
CUK26208	CUK27208	8	35.0	22.0
CUK26209	CUK27209	9	36.5	23.5
CUK26210	CUK27210	10	36.5	25.5
CUK26211	CUK27211	11	37.5	26.0
CUK26212	CUK27212	12	37.5	27.5
CUK26213	CUK27213	13	38.5	29.5
CUK26214	CUK27214	14	38.5	30.5
CUK26215	CUK27215	15	38.5	33.0

3/8"DR. UNIVERSAL JOINT SOCKET

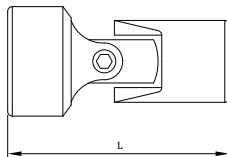
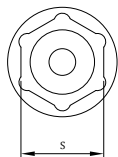

Item No.	S	L(mm)	G
CUK36112	3/8"	43	52.5
CUK36114	7/16"	46	55.0
CUK36116	1/2"	48	61.0
CUK36118	9/16"	48	60.5
CUK36120	5/8"	48	64.0
CUK36122	11/16"	50	72.0
CUK36124	3/4"	50	72.0

Item No.	S	L(mm)	G
CUK36210	10	46	47
CUK36211	11	46	48
CUK36212	12	46	50
CUK36213	13	46	50
CUK36214	14	48	51
CUK36215	15	48	53
CUK36216	16	48	53
CUK36217	17	50	62
CUK36218	18	50	63
CUK36219	19	50	64

12PC 1/4"DR. UNIVERSAL JOINT SOCKET SET



Item No.	12PC-26UJM6
EVA	L:200 x W:94 x H:30 mm
WEIGHT	336 (g)

CONTENT	
1/4"DR. UNIVERSAL JOINT SOCKET (mm)	5, 5.5, 6, 7, 8, 9, 10, 11, 12, 13, 14, 15

UNIVERSAL JOINT SOCKET SET

7PC 1/4"DR. UNIVERSAL SOCKET SET

1/4"



Item No.	7PC-26UJS5
EVA	L:200 x W:65 x H:25 mm
WEIGHT	204 (g)

CONTENT	
1/4"DR. FLEX UNIVERSAL SOCKET	3/16", 1/4", 5/16", 3/8", 7/16", 1/2", 9/16"

7PC 3/8"DR. UNIVERSAL JOINT SOCKET SET

3/8"



Item No.	7PC-05-1
PS TRAY W/ PVC UP-COVER	L:263 x W:106 mm
WEIGHT	500 (g)

CONTENT	
3/8"DR. 6-POINT FLEX UNIVERSAL SOCKET (IN)	3/8", 7/16", 1/2", 9/16", 5/8", 11/16", 3/4"

10PC 3/8"DR. UNIVERSAL JOINT SOCKET SET

3/8"



Item No.	10PC-05A1
PS TRAY W/ PVC UP-COVER	L:308 x W:120 mm
WEIGHT	950 (g)

CONTENT	
3/8"DR. 6-POINT FLEX UNIVERSAL SOCKET (mm)	10, 11, 12, 13, 14, 15, 16, 17, 18, 19

Socket & Wrench

Impact Socket

Air Chisels

Automotive Tools

DRIVE HANDLE TOOLS

RATCHET HANDLE

PEAR HEAD CURVED RATCHET HANDLE

1/4"

3/8"

1/2"



Item No.	S	TEETH	L(mm)	W(mm)	H(mm)	G
PQRHCV1171	1/4"	72	140.5	25.7	23.8	111.5
PQRHCV1172	3/8"	72	200	30.7	28.4	215.0
PQRHCV1173	1/2"	72	255	40.8	40.5	491.5

MINI RATCHET HANDLE

1/4"

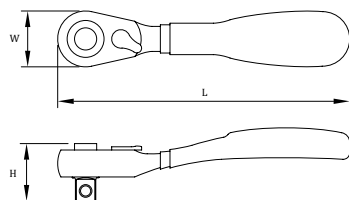

Item No.	S	TEETH	L(mm)	W(mm)	H(mm)	G
PQHM002	1/4"	72	97	17.5	18.5	55

ROUND HEAD RATCHET HANDLE

1/4"

3/8"

1/2"

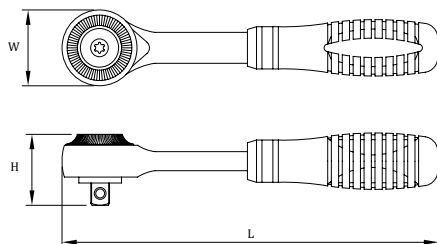

Item No.	S	TEETH	L(mm)	W(mm)	H(mm)	G
PQRA082	1/4"	72	145	26	30	120
PQRA083	3/8"	72	195	30	34	230
PQRA084	1/2"	72	250	38	45	490

RATCHET HANDLE

1/4"

3/8"

1/2"

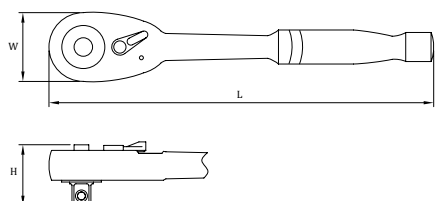

Item No.	S	TEETH	L(mm)	W(mm)	H(mm)	G
PQHAG132	1/4"	72	130	23	11	110
PQHAG133	3/8"	72	197	30	15	275
PQHAG134	1/2"	72	250	37	19	510

RATCHET HANDLE

1/4"

3/8"

1/2"

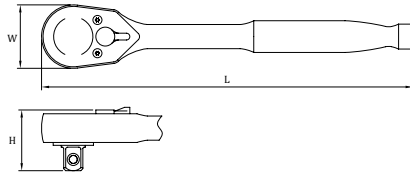

Item No.	S	TEETH	L(mm)	W(mm)	H(mm)	G
PNQHG002	1/4"	36	140	24	18	125
PNQHG003	3/8"	36	190	30	25	300
PNQHG004	1/2"	36	245	42	35	660

Socket & Wrench

Impact Socket

RATCHET HANDLE

1/4"

3/8"

1/2"

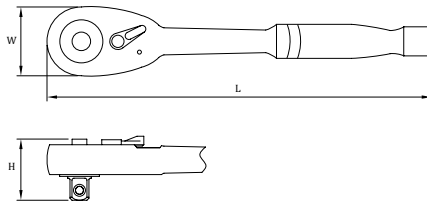

Item No.	S	TEETH	L(mm)	W(mm)	H(mm)	G
PQHA022	1/4"	72	145	21	30	120
PQHA023	3/8"	72	200	30	34	280
PQHA024	1/2"	72	250	39	45	500

Air Chisels

Automotive Tools

ROUND HEAD CURVED RATCHET HANDLE

1/4"

3/8"

1/2"

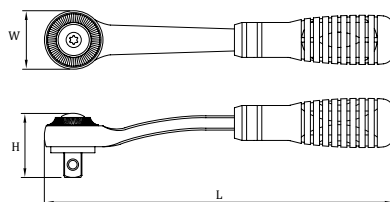

Item No.	S	TEETH	L(mm)	W(mm)	H(mm)	G
PQRA052	1/4"	72	145	26	29	110
PQRA053	3/8"	72	195	30	33	200
PQRA054	1/2"	72	250	39	46	470

DRIVE HANDLE TOOLS

T-HANDLE

MAGNETIC HEX HOLE TURBO SPEED T-HANDLE

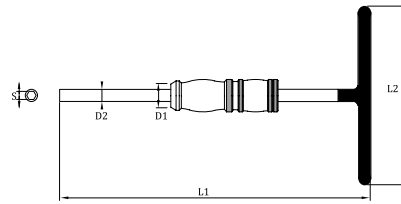

Item No.	S	D1	D2	L1(mm)	L2(mm)	G	Position
CRTH4219	HEX6.5	19	9.50	322	143	318	3

QUICK-RELEASE TURBO SPEED T-HANDLE

1/4"

3/8"

1/2"

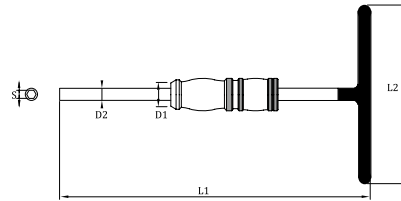

Item No.	S	D1	D2	L1(mm)	L2(mm)	G	Position
CRT4219	1/4"	19	9.5	322	143	313	3
CRT4324	3/8"	24	12.0	325	183	535	3
CRT4430	1/2"	31	16.0	328	243	1050	3

3PC TURBO SPEED T-HANDLE

1/4"

3/8"

1/2"



Item No.	3PC-24D3
TRAY	L:420 x W:280 x H:36 mm
WEIGHT	2125 (g)

CONTENT	
1/4"DR. ADJUSTABLE SLIDING TURBO SPEED T-HANDLE	
3/8"DR. ADJUSTABLE SLIDING TURBO SPEED T-HANDLE	
1/2"DR. ADJUSTABLE SLIDING TURBO SPEED T-HANDLE	

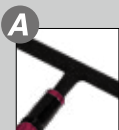

A Rubber handle and cross-patterned component increase friction, easy to use even with slippery hands.



B Patented, specially designed component allows users to turn the handle swiftly and exert their strength more easily.

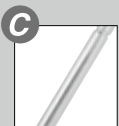

C Extended shank allows users to reach the bolts more easily.

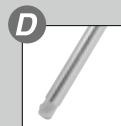

D Different choice for the T-handle head

FLEXIBLE HANDLE

1/4" DR. FLEXIBLE HANDLE

1/4"

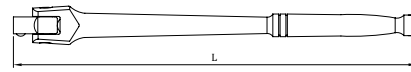

Item No.	L(inch)	G
PFHCR205	5"	346
PFHCR2055	5 1/2"	340
PFHCR206	6"	400

3/8" DR. FLEXIBLE HANDLE

3/8"

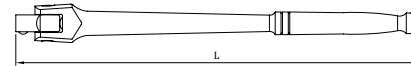

Item No.	L(inch)	G
PFHCR308	8"	280
PFHCR310	10"	340
PFHCR312	12"	400

1/2" DR. FLEXIBLE HANDLE

1/2"

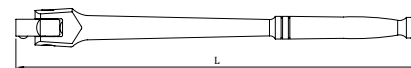

Item No.	L(inch)	G
PFHCR410	10"	496
PFHCR412	12"	560
PFHCR415	15"	670
PFHCR416	16"	690
PFHCR417	17"	700
PFHCR418	18"	860
PFHCR420	20"	1600
PFHCR424	24"	1720

3/4" DR. FLEXIBLE HANDLE HEAVY-DUTY

3/4"

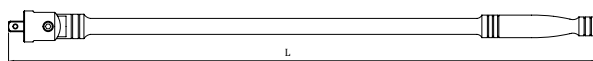

Item No.	L(inch)	G
PFHCR620	20"	1500
PFHCR624	24"	1700
PFHCR640	40"	3300

Socket & Wrench

Impact Socket

Air Chisels

Automotive Tools

DRIVE HANDLE TOOLS

SLIDING T-BAR

SLIDING T-BAR

1/4"

3/8"

1/2"

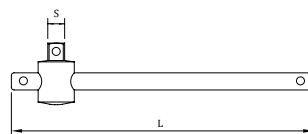

Item No.	S	L(inch)	L(mm)	G
PTB204	1/4"	4.4"	110	44
PTB205	1/4"	4.5"	115	50
PTB206	1/4"	6"	150	70
PTB306	3/8"	6.4"	165	240
PTB308	3/8"	8"	200	300
PTB310	3/8"	10"	250	360
PTB410	1/2"	10"	250	353
PTB412	1/2"	12"	300	412

L-SHAPE HANDLE

L-SHAPE HANDLE

1/2"

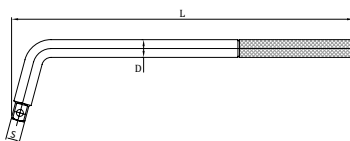

Item No.	S	L(mm)	D	G
LHCR4D	1/2"	285	14.5	500
LHCR4	1/2"	315	14.5	464

SPEEDER HANDLE

SPEEDER HANDLE

1/4"

3/8"

1/2"

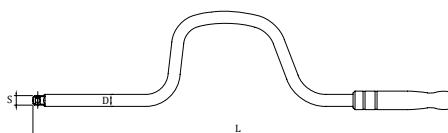

Item No.	S	L(mm)	D	G
A2SPH	1/4"	425	12	375
A3SPH	3/8"	425	12	435
A4SPH	1/2"	425	12	550

EXTENSION BAR

1/4"DR. EXTENSION BAR

1/4"

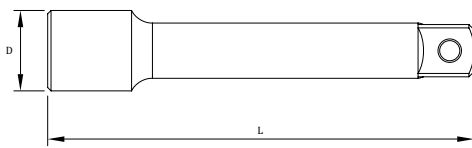

Item No.	L(mm)	L(inch)	D(mm)	G
XCR202	50	2"	12	25
XCR203	75	3"	12	35
XCR204	100	4"	12	50
XCR206	150	6"	12	65
XCR210	250	10"	12	95
XCR212	305	12"	12	115
XCR214	357	14"	12	140

3/8"DR. EXTENSION BAR

3/8"

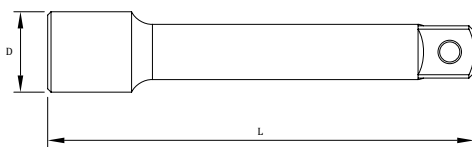

Item No.	L(mm)	L(inch)	D(mm)	G
XCR302	43	1-3/4"	18	45
XCR303	75	3"	18	75
XCR306	150	6"	18	150
XCR308	203	8"	18	190
XCR310	250	10"	18	240
XCR312	305	12"	18	305
XCR318	457	18"	18	400
XCR324	610	24"	18	540
XCR330	762	30"	18	680
XCR336	915	36"	18	820

1/2"DR. EXTENSION BAR

1/2"

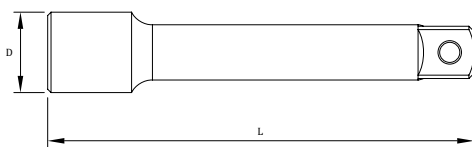

Item No.	L(mm)	L(inch)	D(mm)	G
XCR402	50	2"	24	100
XCR403	75	3"	24	120
XCR405	125	5"	24	180
XCR406	150	6"	24	215
XCR410	250	10"	24	430
XCR412	305	12"	24	500
XCR415	380	15"	24	610
XCR418	457	18"	24	735
XCR424	610	24"	24	990
XCR430	762	30"	24	1245
XCR436	915	36"	24	1500

Socket & Wrench

Impact Socket

Air Chisels

Automotive Tools

SOCKET ACCESSORIES

1/4"DR. MAGNETIC EXTENSION BAR

1/4"

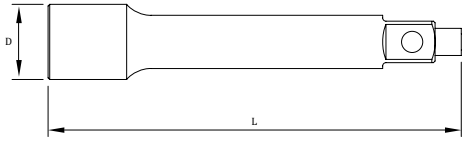

Item No.	L(mm)	L(inch)	D(mm)	G
CXMCR202	50	2"	12	25
CXMCR203	75	3"	12	36
CXMCR204	100	4"	12	46
CXMCR206	150	6"	12	66
CXMCR210	250	10"	12	109
CXMCR212	305	12"	12	115

3/8"DR. MAGNETIC EXTENSION BAR

3/8"

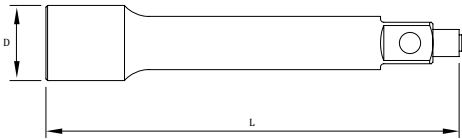

Item No.	L(mm)	L(inch)	D(mm)	G
CXMCR302	43	1-3/4"	18	41
CXMCR303	75	3"	18	78
CXMCR306	150	6"	18	147
CXMCR310	250	10"	18	239
CXMCR312	305	12"	18	305
CXMCR318	457	18"	18	400

1/2"DR. MAGNETIC EXTENSION BAR

1/2"

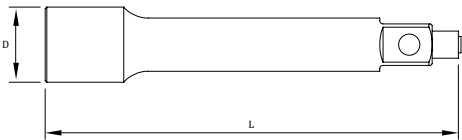

Item No.	L(mm)	L(inch)	D(mm)	G
CXMCR402	50	2"	24	95
CXMCR403	75	3"	24	139
CXMCR405	125	5"	24	223
CXMCR406	150	6"	24	264
CXMCR410	250	10"	24	429
CXMCR412	305	12"	24	500
CXMCR415	381	15"	24	610
CXMCR418	457	18"	24	735

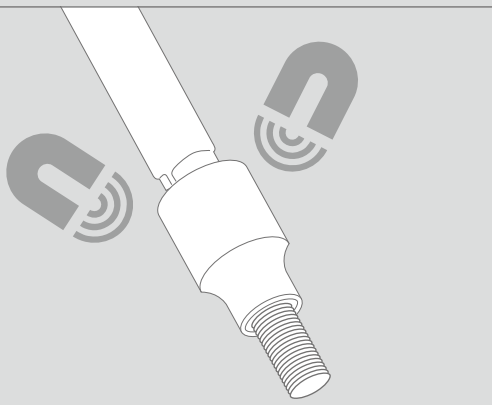

The top head of magnetic extension bar can help to turn every socket into a magnetic socket.

Hold nuts and bolts in place.



1/4"DR. LOCK EXTENSION BAR

1/4"

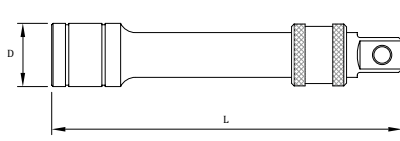

Item No.	L(mm)	L(inch)	D(mm)	G
CXQCR202	50	2"	12	31
CXQCR203	75	3"	12	42
CXQCR204	100	4"	12	52
CXQCR206	150	6"	12	71
CXQCR210	250	10"	12	112
CXQCR214	357	14"	12	147
CXQCR224	600	24"	12	215
CXQCR236	915	36"	12	305

3/8"DR. LOCK EXTENSION BAR

3/8"

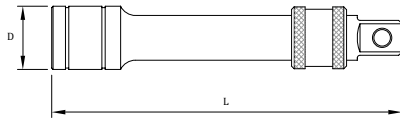

Item No.	L(mm)	L(inch)	D(mm)	G
CXQCR303	75	3"	18	83
CXQCR304	100	4"	18	100
CXQCR306	150	6"	18	152
CXQCR308	200	8"	18	195
CXQCR310	250	10"	18	234
CXQCR312	305	12"	18	290
CXQCR314	357	14"	18	313.5
CXQCR318	457	18"	18	413
CXQCR324	610	24"	18	518
CXQCR336	915	36"	18	790

1/2"DR. LOCK EXTENSION BAR

1/2"

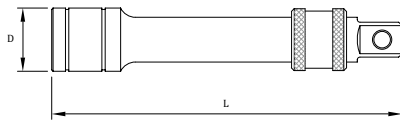

Item No.	L(mm)	L(inch)	D(mm)	G
CXQCR402	50	2"	24	100
CXQCR403	75	3"	24	144
CXQCR405	125	5"	24	227
CXQCR410	250	10"	24	434
CXQCR415	375	15"	24	635
CXQCR420	500	20"	24	840
CXQCR424	610	24"	24	1000
CXQCR436	915	36"	24	1500

- Resist a socket pull-off load
- Prevent accidental socket loss
- Instantly unlock by retracting the knurled ring.



Use only with sockets equipped with an internal ball notch.

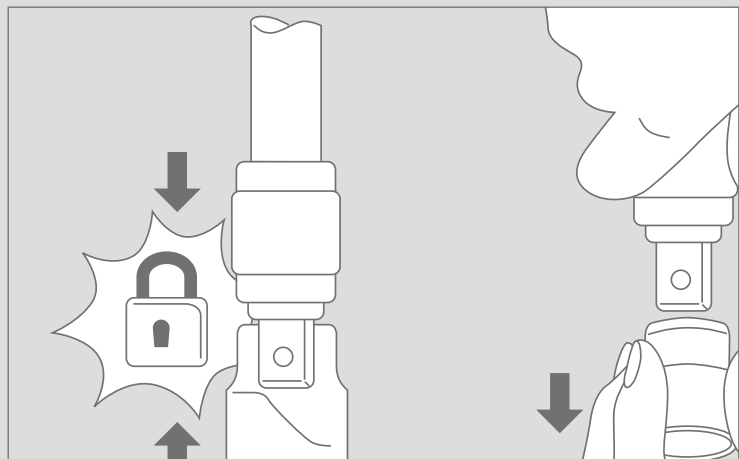

Socket & Wrench

Impact Socket

Air Chisels

Automotive Tools

SOCKET ACCESSORIES

4PC 1/4"DR. LOCK EXTENSION BAR SET

1/4"



Item No.	4PC-14B
PS TRAY W/ PVC UP-COVER	L:410 x W:100 x H:20 mm
WEIGHT	800 (g)

CONTENT	
1/4"DR. LOCK EXTENSION BAR	4", 6", 10", 14"

4PC 3/8"DR. LOCK EXTENSION BAR SET

3/8"



Item No.	4PC-14-3DR
PS TRAY W/ PVC UP-COVER	L:510 x W:120 x H:28 mm
WEIGHT	1165 (g)

CONTENT	
3/8"DR. LOCK EXTENSION BAR	3", 6", 10", 18"

4PC 1/2"DR. LOCK EXTENSION BAR SET

1/2"



Item No.	4PC-14-4DR
PS TRAY W/ PVC UP-COVER	L:445xW:140xH:32 mm
WEIGHT	1500 (g)

CONTENT	
1/2"DR. LOCK EXTENSION BAR	3", 5", 10", 15"

- Resist a socket pull-off load
- Prevent accidental socket loss
- Instantly unlock by retracting the knurled ring.



Use only with sockets equipped with an internal ball notch.

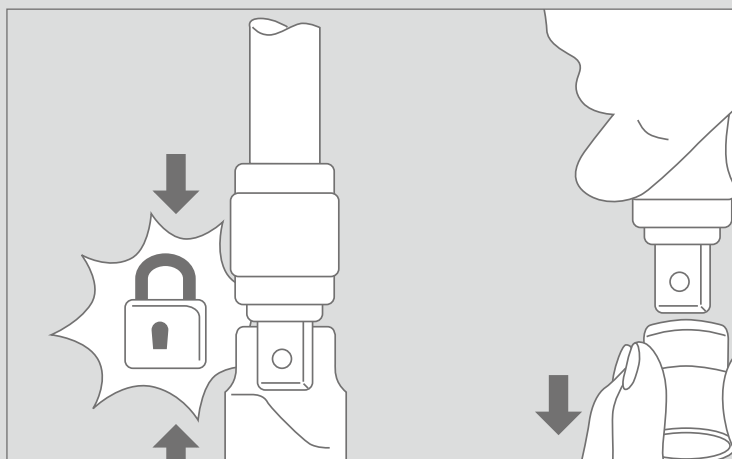

1/4"DR. WOBBLE EXTENSION BAR

1/4"

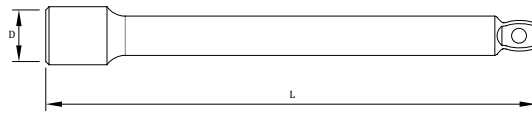

Item No.	L(mm)	L(inch)	D(mm)	G
XWCR202	50	2"	12	25
XWCR203	75	3"	12	35
XWCR204	100	4"	12	50
XWCR206	150	6"	12	64
XWCR210	250	10"	12	95
XWCR212	305	12"	12	115



3/8"DR. WOBBLE EXTENSION BAR

3/8"

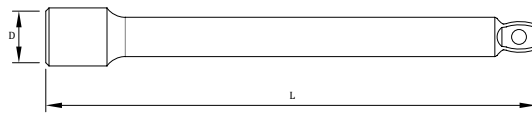

Item No.	L(mm)	L(inch)	D(mm)	G
XWCR302	43	1-3/4"	18	38
XWCR303	75	3"	18	74
XWCR306	150	6"	18	144
XWCR310	250	10"	18	236
XWCR312	305	12"	18	305
XWCR318	457	18"	18	400

1/2"DR. WOBBLE EXTENSION BAR

1/2"

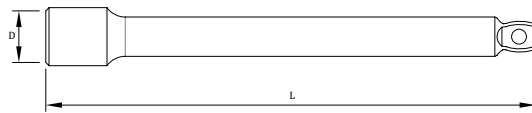

Item No.	L(mm)	L(inch)	D(mm)	G
XWCR402	50	2"	24	100
XWCR403	75	3"	24	120
XWCR405	125	5"	24	220
XWCR410	250	10"	24	426
XWCR415	380	15"	24	610
XWCR418	457	18"	24	735
XWCR424	610	24"	24	990

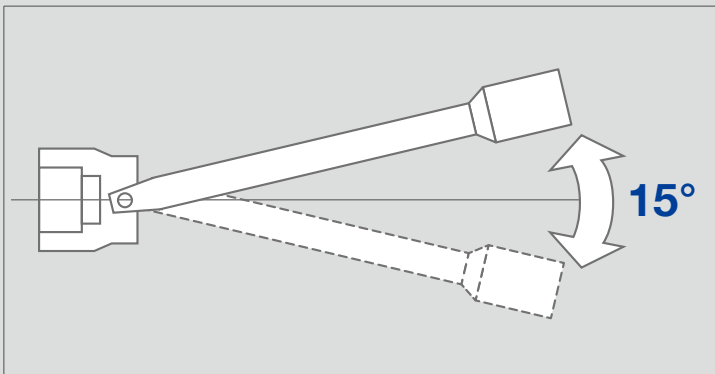

The extension can be used at an angle of around 7.5°

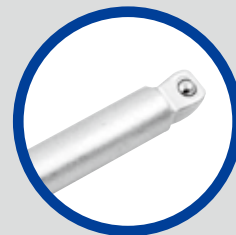

SOCKET ACCESSORIES

ADAPTOR

ADAPTOR

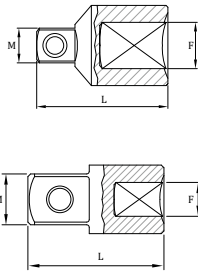

Item No.	F(FEMALE)	M(MALE)	L(mm)	G
FCR203	1/4"	3/8"	27.0	21
FCR304	3/8"	1/2"	36.0	46
FCR406	1/2"	3/4"	54.5	187
FCR608	3/4"	1"	58.0	319

Item No.	F(FEMALE)	M(MALE)	L(mm)	G
FCR302	3/8"	1/4"	27.0	21
FCR403	1/2"	3/8"	36.0	46
FCR604	3/4"	1/2"	54.5	187

QUICK-RELEASE UNIVERSAL JOINT ADAPTOR

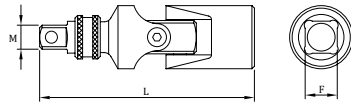

Item No.	F(FEMALE)	M(MALE)	L(mm)	G
UJQM403	3/8"	1/2"	90	61
UJQM304	1/2"	3/8"	80	63

QUICK ADAPTOR

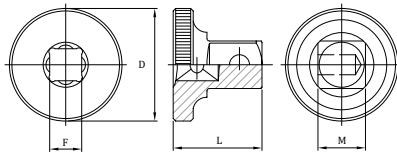

Item No.	F(FEMALE)	M(MALE)	D(mm)	L(mm)	G
FCO203	1/4"	3/8"	28	21	37
FCO304	3/8"	1/2"	36.3	28	73
FCO406	1/2"	3/4"	42.2	35	138

MAGNETIC ADAPTOR

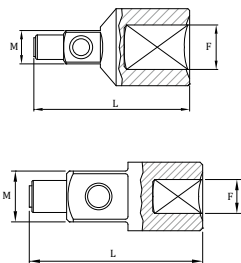

Item No.	F(FEMALE)	M(MALE)	L(mm)	G
FMGE302	3/8"	1/4"	36	27
FMGE403	1/2"	3/8"	45	54
FMGE604	3/4"	1/2"	62	150

Item No.	F(FEMALE)	M(MALE)	L(mm)	G
FMGE203	1/4"	3/8"	35	18
FMGE304	3/8"	1/2"	45	49
FMGE406	1/2"	3/4"	62	145

5PC ADAPTOR SET



Item No.	5PC-02
BLISTER W/ INSERT CARD	L:215 x W108 mm
WEIGHT	400 (g)

SQUARE DRIVE COUPLER

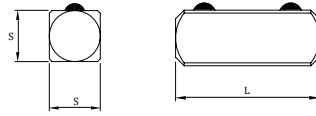

Item No.	S	L(mm)
2CPL	1/4"	20

Socket & Wrench

Impact Socket

UNIVERSAL JOINT

UNIVERSAL JOINT

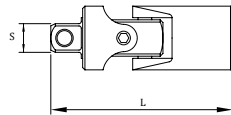

Item No.	S	L(mm)	G
PUJ200	1/4"	36	24
PUJ300	3/8"	50	50
PUJ400	1/2"	68	140

Air Chisels

Automotive Tools

LOCK UNIVERSAL JOINT

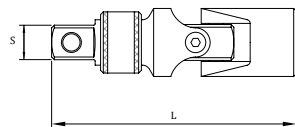

Item No.	S	L(mm)	G
UJQM200	1/4"	53	15
UJQM300	3/8"	74	36
UJQM400	1/2"	95	85

MAGNETIC UNIVERSAL JOINT

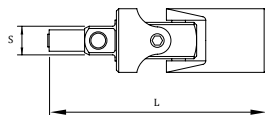

Item No.	S	L(mm)	G
CUJM200	1/4"	43.8	26
CUJM300	3/8"	65.0	53
CUJM400	1/2"	83.0	143

AMERICAN STYLE SOCKET SET

1/4" DRIVE SOCKET SET

9PC 1/4"DR. DEEP SOCKET SET (METRIC)



1/4"



Item No.	9PC-07M2
METAL CASE	L:155 × W:68 × H:35 mm
WEIGHT	387.5 (g)

CONTENT	
1/4"DR. 6PT DEEP SOCKET	5.5, 6, 7, 8, 9, 10, 12, 13

*The set number includes the metal case or blow case.

16PC 1/4"DR. SOCKET SET (METRIC)



1/4"



Item No.	16PC-01M
METAL CASE	L:244 × W:118 × H:37 mm
WEIGHT	835 (g)

CONTENT	
1/4"DR. 6-POINT SOCKET	4, 5, 6, 7, 8, 9, 10, 12, 13
1/4"DR. METAL DISC	
1/4"DR. UNIVERSAL JOINT	
1/4"DR. SPINNER HANDLE	6"
1/4"DR. EXTENSION BAR	2", 6"
1/4"DR. QUICK RELEASE RATCHET HANDLE	

24PC 1/4"DR. DEEP SOCKET SET (METRIC)



1/4"



Item No.	24PC-08-1
METAL CASE	L:244 × W:118 × H:37 mm
WEIGHT	1300 (g)

CONTENT	
1/4"DR. 6-POINT SOCKET	4, 5, 6, 7, 8, 9, 10, 12, 13
1/4"DR. 6-POINT DEEP SOCKET	4, 5, 6, 7, 8, 9, 10, 12, 13
1/4"DR. UNIVERSAL JOINT	
1/4"DR. SPINNER HANDLE	6"
1/4"DR. EXTENSION BAR	2", 6"
1/4"DR. QUICK RELEASE RATCHET HANDLE	

42PC 1/4"DR. DEEP SOCKET SET (METRIC+SAE)



1/4"



Item No.	42PC-06B-3
BLOW CASE	L:270 × W:200 × H:60 mm
WEIGHT	1590 (g)

CONTENT	
1/4"DR. 6-POINT SOCKET	4, 4.5, 5, 5.5, 6, 7, 8, 9, 10, 11, 12, 13
1/4"DR. 6-POINT SOCKET (IN)	3/16", 1/4", 9/32", 11/32", 3/8", 1/2"
1/4"DR. 6-POINT DEEP SOCKET	4, 4.5, 5, 5.5, 6, 7, 8, 9, 10, 11, 12, 13
1/4"DR. 6-POINT DEEP SOCKET (IN)	3/16", 1/4", 3/8", 1/2"
1/4"DR. SPINNER HANDLE	6-1/2"
1/4"DR. EXTENSION BAR	2", 4", 6"
1/4"DR. UNIVERSAL JOINT	
1/4"DR. SLIDING T-BAR	110mm
1/4"DR. QUICK RELEASE RATCHET HANDLE	

*The set number includes the metal case or blow case.

24PC 1/4"DR. SOCKET SET (SAE)



1/4"



Item No.	24PC-05B
TWO SIDE TYPE BLOW CASE	L:270 x W:200 mm
WEIGHT	1500 (g)

CONTENT	
1/4"DR. 6PT SOCKETS:(CR-V)	3/16", 7/32", 1/4", 9/32", 5/16", 11/32", 3/8", 7/16", 1/2"
1/4"DR. 6PT DEEP SOCKETS:(CR-V)	3/16", 7/32", 1/4", 9/32", 5/16", 11/32", 3/8", 7/16", 1/2"
1/4"DR. 2" & 6" EXTENSION BAR.(CR-V)	
1/4"DR. 6" SPINNER HANDLE W/EXT.(CR-V)	
1/4"DR. QUICK RELEASE RATCHET HANDLE	

28PC 1/4"DR. SOCKET SET (METRIC)



1/4"



Item No.	28PC-12B
TWO SIDE TYPE BLOW CASE	L:270 x W:200 mm
WEIGHT	1500 (g)

CONTENT	
1/4"DR. 6PT SOCKETS:(CR-V)	4, 5, 5.5, 6, 7, 8, 9, 10, 11, 12, 13 mm
1/4"DR. 6PT DEEP SOCKETS:(CR-V)	4, 5, 5.5, 6, 7, 8, 9, 10, 11, 12, 13 mm
1/4"DR. 2" & 6" EXTENSION BAR.(CR-V)	
1/4"DR. 6" SPINNER HANDLE W/EXT.(CR-V)	
1/4"DR. UNIVERSAL JOINT.(CR-V)	
1/4"DR. QUICK RELEASE RATCHET HANDLE	

42PC 1/4"DR. SOCKET SET (METRIC+SAE)



1/4"



Item No.	42PC-02B
TWO SIDE TYPE BLOW CASE	L:270 x W:200 mm
WEIGHT	2500 (g)

CONTENT	
1/4"DR. SOCKETS:(SAE)(CR-V)	3/16", 7/32", 1/4", 9/32", 5/16", 11/32", 3/8", 7/16", 1/2"
1/4"DR. SOCKETS:(mm)(CR-V)	4, 5, 6, 7, 8, 9, 10, 11, 12 mm
1/4"DR. DEEP SOCKETS:(SAE)(CR-V)	3/16", 7/32", 1/4", 9/32", 5/16", 11/32", 3/8", 7/16", 1/2"
1/4"DR. DEEP SOCKETS:(mm)(CR-V)	4, 5, 6, 7, 8, 9, 10, 11, 12 mm
1/4"DR. 5" (QUICK RELEASE) CURVED RATCHET HANDLE. (72 TEETH)(TWIN TEETH)(CRV)	
1/4"DR. DR. 2" & 4" EXTENSION BAR(CR-V)	
1/4"DR. UNIVERSAL JOINT. (CR-V)	
1/4"DR. 6" SPINNER HANDLE W/EXT. (CR-V)	

AMERICAN STYLE SOCKET SET

10PC 1/4"DR. SOCKET SET (SAE)

6

1/4"

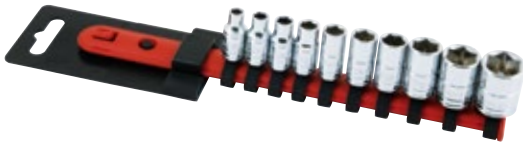

Item No.	10PC-72S-2DR
HOLDER BAR	L: 215 mm
WEIGHT	217 (g)

CONTENT	
1/4"DR. 6PT SOCKET	3/16", 7/32", 1/4", 9/32", 5/16", 11/32", 3/8", 7/16", 1/2", 9/16"

13PC 1/4"DR. SOCKET SET (METRIC)

6

1/4"

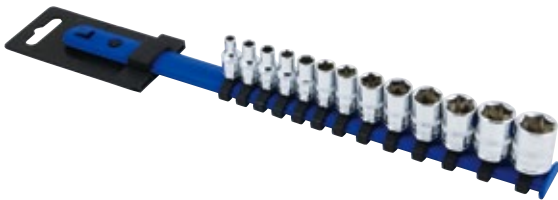

Item No.	13PC-37M-2DR
HOLDER BAR	L: 215 mm
WEIGHT	314 (g)

CONTENT	
1/4"DR. 6PT DEEP SOCKET	4, 5, 5.5, 6, 7, 8, 9, 10, 11, 12, 13, 14, 15

10PC 1/4"DR. DEEP SOCKET SET (METRIC)

6

1/4"



Item No.	10PC-72LM-2DR
HOLDER BAR	L: 215 mm
WEIGHT	460 (g)

CONTENT	
1/4"DR. 6PT DEEP SOCKET	6, 7, 8, 9, 10, 11, 12, 13, 14, 15

10PC 1/4"DR. DEEP SOCKET SET (SAE)

6

1/4"

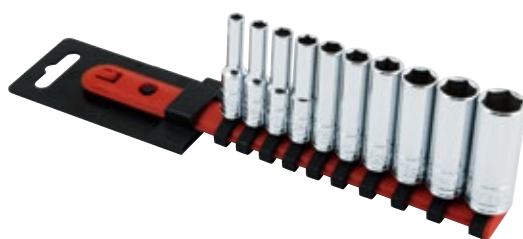

Item No.	10PC-72LS-2DR
HOLDER BAR	L: 215 mm
WEIGHT	374 (g)

CONTENT	
1/4"DR. 6PT DEEP SOCKET	3/16", 7/32", 1/4", 9/32", 5/16", 11/32", 3/8", 7/16", 1/2", 9/16"

3/8" DRIVE SOCKET SET

15PC 3/8"DR. SOCKET SET



3/8"



Item No.	15PC-01B
BLOW CASE	L:260 x W:119 mm
WEIGHT	1583 (g)

CONTENT	
3/8"DR. 6PT SOCKET:(mm)(CR-V)	9, 10, 11, 12, 13, 14, 15, 16, 17, 18, 19 mm
3/8"DR. 8" QUICK RELEASE RATCHET HANDLE	
3/8"DR. 6" EXTENSION BAR.(CR-V)	

Socket & Wrench

Impact Socket

Air Chisels

Automotive Tools

30PC 3/8"DR. SOCKET SET (METRIC)



3/8"



Item No.	30PC-01B
BLOW CASE	L:355 x W:256 mm
WEIGHT	4250 (g)

CONTENT	
3/8"DR. 6PT SOCKET:(mm)(CR-V)	8, 9, 10, 11, 12, 13, 14, 15, 16, 17, 18, 19 mm
3/8"DR. 6PT DEEP SOCKET:(mm)(CR-V)	8, 9, 10, 11, 12, 13, 14, 15, 16, 17, 18, 19 mm
3/8"DR. 8" QUICK RELEASE RATCHET HANDLE	
3/8"DR. 3" & 6" EXTENSION BAR.(CR-V)	
3/8"DR. UNIVERSAL JOINT.(CR-V)	
3/8"DR. 8" FLEX HANDLE (CR-V)	

AMERICAN STYLE SOCKET SET

10PC 3/8"DR. DEEP SOCKET SET (METRIC)



3/8"



Item No.	10PC-07M2
METAL CASE	L:214 × W:82 × H:40 mm
WEIGHT	875 (g)

CONTENT	
3/8"DR. 6-POINT DEEP SOCKET	8, 10, 11, 12, 13, 14, 16, 17, 19

*The set number includes the metal case or blow case.

16PC 3/8"DR. SOCKET SET (METRIC)



3/8"



Item No.	16PC-02M
METAL CASE	L:244 × W:188 × H:37 mm
WEIGHT	1500 (g)

CONTENT	
3/8"DR. 6-POINT SOCKET	10, 11, 12, 13, 14, 15, 17, 19, 21, 22
3/8"DR. SPARK PLUG SOCKET	16, 21
3/8"DR. EXTENSION BAR	3", 6"
3/8"DR. QUICK RELEASE RATCHET HANDLE	

*The set number includes the metal case or blow case.

20PC 3/8"DR. DEEP SOCKET SET (METRIC)



3/8"



Item No.	20PC-05M
METAL CASE	L:280 × W:130 × H:41 mm
WEIGHT	2400 (g)

CONTENT	
3/8"DR. 6-POINT SOCKET	10, 11, 13, 14, 15, 17, 19
3/8"DR. 6-POINT SEMI-DEEP SOCKET	10, 11, 12, 13
3/8"DR. 6-POINT DEEP SOCKET	14, 15, 17, 19
3/8"DR. EXTENSION BAR	3"
3/8"DR. UNIVERSAL JOINT	
3/8"DR. QUICK RELEASE RATCHET HANDLE	
3/8"DR. FLEXIBLE HANDLE	8-1/2"

*The set number includes the metal case or blow case.

50PC 3/8"DR. DEEP SOCKET SET (METRIC+SAE)



3/8"



Item No.	50PC-04B-3
BLOW CASE	L:447 × W:338 × H:84 mm
WEIGHT	4750 (g)

CONTENT	
3/8"DR. 6-POINT SOCKET	8, 9, 10, 11, 12, 13, 14, 15, 16, 17, 18, 19, 20, 21, 22
3/8"DR. 6-POINT SOCKET (IN)	3/8", 1/2", 9/16", 11/16", 13/16"
3/8"DR. 6-POINT DEEP SOCKET	8, 9, 10, 11, 12, 13, 14, 15, 16, 17, 18, 19, 20, 21, 22
3/8"DR. 6-POINT DEEP SOCKET (IN)	3/8", 1/2", 9/16", 11/16", 13/16"
3/8"DR. QUICK RELEASE RATCHET HANDLE	
3/8"DR. SPARK PLUG SOCKET	16, 18, 21
3/8"DR. SLIDING T BAR	200 mm
3/8"DR. UNIVERSAL JOINT	
3/8"DR. EXTENSION BAR	43, 75, 150

*The set number includes the metal case or blow case.

11PC 3/8"DR. SOCKET SET (SAE)

6 3/8"



Item No.	11PC-50S-3DR
HOLDER BAR	L: 305 mm
WEIGHT	580 (g)

CONTENT	
3/8"DR. 6PT SOCKET	1/4", 5/16", 3/8", 7/16", 1/2", 9/16", 5/8", 11/16", 3/4", 13/16", 7/8"

14PC 3/8"DR. SOCKET SET (METRIC)

6 3/8"



Item No.	14PC-38M-3DR
HOLDER BAR	L: 305 mm
WEIGHT	578 (g)

CONTENT	
3/8"DR. 6PT SOCKET	6, 7, 8, 9, 10, 11, 12, 13, 14, 15, 16, 17, 18, 19

9PC 3/8"DR. DEEP SOCKET SET (SAE)

6 3/8"



Item No.	9PC-54LS-3DR
HOLDER BAR	L: 305 mm
WEIGHT	992 (g)

CONTENT	
3/8"DR. 6PT DEEP SOCKET	3/8", 7/16", 1/2", 9/16", 5/8", 11/16", 3/4", 13/16", 7/8"

10PC 3/8"DR. DEEP SOCKET SET (METRIC)

6 3/8"



Item No.	10PC-72LM-3DR
HOLDER BAR	L: 305 mm
WEIGHT	950 (g)

CONTENT	
3/8"DR. 6PT DEEP SOCKET	10, 11, 12, 13, 14, 15, 16, 17, 18, 19

Socket & Wrench

Impact Socket

Air Chisels

Automotive Tools

AMERICAN STYLE SOCKET SET

1/2" DRIVE SOCKET SET

19PC 1/2"DR. SOCKET SET (METRIC)



1/2"



Item No.	19PC-01B-2
TWO COLOR BLOW CASE	L:355 x W:270 mm
WEIGHT	4750 (g)

CONTENT	
1/2"DR. 6PT SOCKET:(mm)(CR-V)	12, 13, 14, 15, 16, 17, 18, 19, 20, 21, 22, 23, 24 mm
1/2"DR. 10" QUICK RELEASE RATCHET HANDLE	
1/2"DR. 5" & 10" EXTENSION BAR.(CR-V)	
1/2"DR. UNIVERSAL JOINT.(CR-V)	
1/2"DR. 15" FLEX HANDLE	

55PC 1/2"DR. SOCKET SET (METRIC+SAE)



1/2"



Item No.	55PC-01B
BLOW CASE	L:410 x W:352 mm
WEIGHT	10500 (g)

CONTENT	
1/2"DR. SOCKETS:(CR-V)(SAE)	3/8", 7/16", 1/2", 9/16", 5/8", 11/16", 3/4", 13/16", 7/8", 15/16", 1", 1-1/16", 1-1/8", 1-3/16", 1-1/4"
1/2"DR. SOCKETS:(CR-V)(mm)	10, 11, 12, 13, 14, 15, 16, 17, 18, 19, 21, 22, 23, 24, 27, 30, 32 mm
1/2"DR. DEEP SOCKETS:(CR-V)(SAE)	7/16", 1/2", 9/16", 5/8", 11/16", 3/4", 7/8"
1/2"DR. DEEP SOCKETS:(CR-V)(mm)	10, 12, 13, 14, 15, 16, 17, 18, 19, 21 mm
1/2"DR. 250mm (10") SLIDING T BAR.(CR-V)	
1/2"DR. EXTENSION BAR.(CR-V)	50 mm , 125 mm , 250 mm
1/2"DR. UNIVERSAL JOINT.(CR-V)	
1/2"DR. 250mm (10")QUICK RELEASE CURVED RATCHET HANDLE.	

13PC 1/2"DR. SOCKET SET (METRIC)

6

1/2"



Item No.	13PC-03B
METAL CASE	L:307 × W:108 × H:49 mm
WEIGHT	2140 (g)

CONTENT	
1/2"DR. 6-POINT SOCKET	10, 11, 12, 13, 14, 15, 17, 19, 21, 22
1/2"DR. EXTENSION BAR	5"
1/2"DR. QUICK RELEASE RATCHET HANDLE	

*The set number includes the metal case or blow case.

19PC 1/2"DR. SOCKET SET (METRIC)

6

1/2"



Item No.	19PC-02M
METAL CASE	L:462 × W:130 × H:48 mm
WEIGHT	3000 (g)

CONTENT	
1/2"DR. 6-POINT SOCKET	11, 13, 14, 15, 17, 19, 21, 22, 23, 24, 27, 30, 32
1/2"DR. EXTENSION BAR	5"
1/2"DR. FLEXIBLE HANDLE	457 mm
1/2"DR. QUICK RELEASE RATCHET HANDLE	
1/2"DR. SPARK PLUG SOCKET	16, 21

*The set number includes the metal case or blow case.

24PC 1/2"DR. SOCKET SET (METRIC)

6

1/2"



Item No.	24PC-09-1
METAL CASE	L:445 × W:187 × H:50 mm
WEIGHT	3660 (g)

CONTENT	
1/2"DR. 6-POINT SOCKET	10, 11, 12, 13, 14, 15, 16, 17, 18, 19, 20, 21, 22, 23, 24, 27, 30, 32
1/2"DR. EXTENSION BAR	5", 10"
1/2"DR. SLIDING T BAR	255mm
1/2"DR. UNIVERSAL JOINT	
1/2"DR. QUICK RELEASE RATCHET HANDLE	

*The set number includes the metal case or blow case.

Socket & Wrench

Impact Socket

Air Chisels

Automotive Tools

AMERICAN STYLE SOCKET SET

25PC 1/2"DR. SOCKET SET (METRIC)



1/2"



Item No.	25PC-01M
METAL CASE	L:445 × W:187 × H:50 mm
WEIGHT	4000 (g)

CONTENT	
1/2"DR. 6-POINT SOCKET	10, 11, 12, 13, 14, 15, 16, 17, 18, 19, 20, 21, 22, 23, 24, 27, 30, 32
1/2"DR. EXTENSION BAR	5"
1/2"DR. SLIDING T BAR	255 mm
1/2"DR. UNIVERSAL JOINT	
1/2"DR. QUICK RELEASE RATCHET HANDLE	10"
1/2"DR. SPARK PLUG SOCKET	16, 21

*The set number includes the metal case or blow case.

35PC 1/2"DR. SOCKET SET (METRIC)



1/2"



Item No.	35PC-03C-3
BLOW CASE	L:381 × W:287 × H:80 mm
WEIGHT	4000 (g)

CONTENT	
1/2"DR. 6-POINT SOCKET	10, 11, 12, 13, 14, 15, 16, 17, 18, 19, 20, 21, 22, 23, 24, 25, 26, 27, 29, 30, 32
1/2"DR. STAR SOCKET	E10, E12, E14, E16
1/2"DR. SPARK PLUG SOCKET	16, 18, 21
1/2"DR. QUICK RELEASE RATCHET HANDLE	
1/2"DR. SLIDING T BAR	250 mm
1/2"DR. UNIVERSAL JOINT	
1/2"DR. EXTENSION BAR (mm)	75, 125, 250 mm

*The set number includes the metal case or blow case.

10PC 1/2"DR. DEEP SOCKET SET (METRIC)



1/2"



Item No.	10PC-72LM-4DR
HOLDER BAR	L: 305 mm
WEIGHT	1295 (g)

CONTENT	
1/2"DR. 6PT DEEP SOCKET	10, 11, 12, 13, 14, 15, 16, 17, 18, 19

11PC 1/2"DR. SOCKET SET (SAE)



1/2"



Item No.	11PC-50S-4DR
HOLDER BAR	L: 432 mm
WEIGHT	1308 (g)

CONTENT	
1/2"DR. 6PT SOCKET	1/2", 9/16", 5/8", 11/16", 3/4", 13/16", 7/8", 15/16", 1", 1-1/16", 1-1/8"

15PC 1/2"DR. SOCKET SET (METRIC)



1/2"



Item No.	15PC-20M-4DR
HOLDER BAR	L: 432 mm
WEIGHT	1268 (g)

CONTENT	
1/2"DR. 6PT SOCKET	10, 11, 12, 13, 14, 15, 16, 17, 18, 19, 20, 21, 22, 23, 24

Socket & Wrench

Impact Socket

Air Chisels

Automotive Tools

EUROPEAN STYLE SOCKET SET

NEW BLOW MOLD CASE

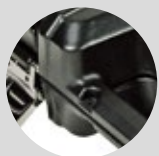

- Security hole (anti-theft)



- Unbreakable stainless-steel buckles
- Red plastic protector



- Steel pin to hold two side blow case
- More durable and beautiful than traditional one-piece blow case



21PC 3/4"DR. SOCKET SET

3/4"



Item No.	21PC-28A
2 COLOR BLOW CASE	L:445 x W:187 mm
WEIGHT	1470 (g)

CONTENT	
3/4"DR. 6PT SOCKETS:(CR-V)	19, 21, 22, 23, 24, 26, 27, 29, 30, 32, 35, 36,38, 41, 46, 50 mm
3/4"DR. QUICK RELEASE RATCHET HANDLE.(CR-V)	5", 10"
3/4"DR. SLIDING T BAR.(CR-V)	450 mm
3/4"DR. EXTENSION BAR.(CR-V)	100 mm & 200 mm & 400 mm

40PC 1/2"DR. TOOL KIT (METRIC)

1/2"



Item No.	40PC-18
2 COLOR BLOW CASE	L:383 x W:272 mm
WEIGHT	2336 (g)

CONTENT	
1/2"DR. SUPER LOCK SOCKETS:(CR-V)	8, 9, 10, 11, 12, 13, 14, 15, 16, 17, 18, 22, 23, 24, 27, 30, 32 mm
1/2"DR. DEEP SUPER LOCK SOCKETS:(CR-V)	10, 13, 17, 19 mm
1/2"DR. SPARK PLUG SOCKET:(CR-V)	16 mm & 21 mm
1/2"DR. UNIVERSAL JOINT:(CR-V)	
1/2"DR. EXTENSION BAR:(CR-V)	125 mm & 250 mm
1/2"DR. QUICK RELEASE RATCHET HANDLE.(72T) (CR-V)	
3/8"(F)x1/2"(M) T-BAR ADAPTOR.(CR-V)	
COMB. WRENCHES:(CR-V)	8, 10, 11, 12, 13, 14, 17, 19, 22 mm

Socket & Wrench

Impact Socket

Air Chisels

Automotive Tools

46PC 1/4"DR. SOCKET SET (METRIC)

1/4"



Item No.	46PC-16
2 COLOR BLOW CASE	L:300 x W:180 mm
WEIGHT	2016 (g)

CONTENT	
13PC-1/4"DR. SUPER LOCK SOCKETS:(CR-V)	4, 4.5, 5, 5.5, 6, 7, 8, 9, 10, 11, 12, 13, 14 mm
1/4"DR. QUICK RELEASE RATCHET HANDLE.(72T) (CR-V)	
1/4"DR. EXTENSION BAR.(CR-V)	50 mm & 100 mm
1/4"DR. FLEXIBLE EXTENSION BAR.(CR-V)	150 mm
1/4"DR. UNIVERSAL JOINT.(CR-V)	
1/4"DR. SLIDING T BAR.(CR-V)	115 mm
1/4"DR. 6" SPINNER HANDLE W/EXT.(CR-V)	
1/4"DR. 1/4" COUPLER ADAPTOR.(CR-V)	
HEX KEY WRENCHES:(CR-V)	1.27, 1.5, 2, 2.5 mm
1/4"DR. BIT SOCKETS:(BIT:S2, ZINC PHOSPHATE FINISHED; SOCKET:CR-V)	HEX: 3, 4, 5, 6, 7, 8 mm SLOTTED: 4, 5.5, 7 mm PHILLIPS: PH1, PH2, PH3 POZI: PZ1, PZ2, PZ3 STAR: T10, T15, T20, T25, T30, T40

EUROPEAN STYLE SOCKET SET

62PC 1/2"DR. SOCKET SET (METRIC) (MAT FINISHED)

1/2"



Item No.	62PC-08
2 COLOR BLOW CASE	L:383 x W:272 mm
WEIGHT	2352 (g)

CONTENT	
1/2"DR. SUPER LOCK SOCKETS:(CR-V)	10, 11, 12, 13, 14, 15, 16, 17, 18, 19, 20, 21, 22, 23, 24, 27, 30, 32 mm
1/2"DR. DEEP SUPER LOCK SOCKETS:(CR-V)	10, 11, 12, 13, 14, 17, 19, 22 mm
1/2"DR. SPARK PLUG SOCKET.(CR-V)	16 mm & 21 mm
1/2"DR. UNIVERSAL JOINT.(CR-V)	
1/2"DR. EXTENSION BAR.(CR-V)	75 mm & 125 mm & 250 mm
1/2"DR. QUICK RELEASE RATCHET HANDLE.(72T) (CR-V)	
3/8"(F)x1/2"(M) T-BAR ADAPTOR.(CR-V)	
1/2"DR. 5/16" COUPLER ADAPTOR .(CR-V)	
5/16" HEX BITS:(L:30mm)(CR-V)(ZINC PHOSPHATE FINISHED)	PHILLIPS: PH1, PH2, PH3, PH4 SLOTTED: 8, 10, 12 mm POZI: PZ1, PZ2, PZ3, PZ4 HEX: 5, 5.5, 6, 7, 8, 9, 10, 12 mm STAR: T20, T25, T27, T30, T40, T45, T50, T55

80PC 1/4"DR. & 1/2"DR. SOCKET SET (METRIC) (MAT FINISHED)

1/4"

1/2"



Item No.	80PC-05-JXK
2 COLOR BLOW CASE	L:452 x W:340 mm
WEIGHT	2112 (g)

CONTENT	
1/4"DR. 6PT SUPER LOCK SOCKETS:(CR-V)	4, 5, 6, 7, 8, 9, 10, 11, 12, 13 mm
1/2"DR. 6PT SUPER LOCK SOCKETS:(CR-V)	13, 14, 15, 16, 17, 18, 19, 22, 24, 27, 30, 32 mm
1/4"DR. QUICK RELEASE RATCHET HANDLE. (72 TEETH)(CR-V)	
1/4"DR. UNIVERSAL JOINT.(CR-V)	
1/4"DR. 6" SPINNER HANDLE W/EXT.(CR-V)	
1/4"DR. EXTENSION BAR.(CR-V)	100 mm
1/4"DR. SLIDING T-BAR.(CR-V)	115 mm
1/4"DR. 1/4" COUPLER ADAPTOR.(CR-V)	
1/2"DR. (6PT) SPARK PLUG SOCKET.(CR-V)	16 mm & 21 mm
1/2"DR. QUICK RELEASE RATCHET HANDLE. (72 TEETH)(CR-V)	
1/2"DR. EXTENSION BAR.(CR-V)	125 mm & 250 mm
1/2"DR. UNIVERSAL JOINT.(CR-V)	
3/8"(F)x1/2"(M) T-BAR ADAPTOR.(CR-V)	
300 GRAM HAMMER W/WOOD HANDLE.	
7" LOCKING PLIER	
6" COMBINATION PLIER.	
MAGNETIC TELESCOPIC EXTENSION BAR.	
SCREWDRIVERS:(8660)	SLOTTED: 5.5x100 mm, 6.5x150 mm PHILLIPS: PH1x75 mm, PH2x100 mm
27PC-1/4" BITS (L:25mm)(CR-V)(ZINC PHOSPHATE FINISHED) W/5PC PE HOLDER:	HEX: 2, 3, 4, 5, 6 mm SLOTTED: 3, 4, 5, 6, 7 mm PHILLIPS: PH0, PH1, PH2, PH3, PH4 POZI: PZ0, PZ1, PZ2, PZ3, PZ4 STAR: T10, T15, T20, T25, T27, T30, T40
COMB. WRENCHES:(CR-V)	8, 10, 12, 13, 14, 15, 17, 19, 22 mm



82PC 1/4" & 1/2"DR. TOOL KIT (METRIC) (MAT FINISHED)

1/4"

1/2"



Item No.	82PC-08C
2 COLOR BLOW CASE	L:383 x W:272 mm
WEIGHT	2380 (g)

CONTENT	
1/4"DR. SUPER LOCK SOCKETS:(CR-V)	4, 4.5, 5, 5.5, 6, 7, 8, 9, 10, 11, 12, 13, 14 mm
1/2"DR. SUPER LOCK SOCKETS:(CR-V)	13, 14, 15, 16, 17, 18, 19, 22, 24, 27, 30, 32 mm
1/4"DR. FLEXIBLE EXTENSION BAR.(CR-V)	150 mm
1/4"DR. SLIDING T BAR.(CR-V)	115 mm
1/4"DR. UNIVERSAL JOINT.(CR-V)	
1/4"DR. EXTENSION BAR.(CR-V)	50 mm & 100 mm
1/4"DR. 6" SPINNER HANDLE W/EXT.(CR-V)	
1/4"DR. QUICK RELEASE RATCHET HANDLE.(72T) (CR-V)	
1/2"DR. SPARK PLUG SOCKET.(CR-V)	16 mm & 21 mm
1/2"DR. UNIVERSAL JOINT.(CR-V)	
1/2"DR. EXTENSION BAR.(CR-V)	125 mm & 250 mm
3/8"(F)x1/2"(M) T-BAR ADAPTOR.(CR-V)	
1/2"DR. QUICK RELEASE RATCHET HANDLE.(72T) (CR-V)	
1/2"DR. 5/16" COUPLER ADAPTOR.(CR-V)	
1/4" HEX BIT ADAPTOR.(L:30mm)(CR-V)(ZINC PHOSPHATE FINISHED)	
1/4"DR. BIT SOCKETS:(BIT:S2,ZINC PHOSPHATE FINISHED; SOCKET:CR-V)	HEX: 3, 4, 5, 6 mm STAR: T8, T10, T15, T20, T25, T30 SLOTTED: 4, 5.5, 7 mm PHILLIPS: PH1, PH2 POZI: PZ1, PZ2
5/16" HEX BITS:(L:30mm)(CR-V)(ZINC PHOSPHATE FINISHED)	HEX: 8, 10, 12, 14 mm STAR: T40, T45, T50, T55 SLOTTED: 8, 10, 12 mm PHILLIPS: PH3, PH4 POZI: PZ3, PZ4
COMB. WRENCHES:(CR-V)	8, 10, 11, 12, 13, 14, 17, 19, 22 mm

84PC 1/4"DR. & 1/2"DR. TOOL KIT (MAT FINISHED)

1/4"

1/2"



Item No.	84PC-06A
2 COLOR BLOW CASE	L:383 x W:272 mm
WEIGHT	2382 (g)

CONTENT	
1/4"DR. 6PT SUPER LOCK SOCKETS:(CR-V)	6, 7, 8, 9, 10, 11, 12, 13 mm
1/4"DR. 6PT DEEP SUPER LOCK SOCKETS:(CR-V)	8, 10, 12, 13 mm
1/2"DR. 6PT SUPER LOCK SOCKETS:(CR-V)	10, 11, 12, 13, 14, 15, 16, 17, 19, 22, 24, 27, 30, 32 mm
1/4"DR. QUICK RELEASE RATCHET HANDLE.(72 TEETH)(CR-V)	
1/4"DR. UNIVERSAL JOINT.(CR-V)	
1/4"DR. 6" SPINNER HANDLE W/EXT.(CR-V)	
1/4"DR. 300MM EXTENSION BAR.(CR-V)	
1/4"DR. 50MM & 150MM 2-WAY WOBBLE EXTENSION BAR.(CR-V)	
1/4"DR. 115MM SLIDING T-BAR.(CR-V)	
1/4"DR. 1/4" COUPLER ADAPTOR.(CR-V)	
1/2"DR. 16MM & 21MM (6PT) SPARK PLUG SOCKET.(CR-V)	
1/2"DR. QUICK RELEASE RATCHET HANDLE.(72 TEETH)(CR-V)	
1/2"DR. 125MM & 250MM EXTENSION BAR.(CR-V)	
1/2"DR. UNIVERSAL JOINT.(CR-V)	
3/8"(F)x1/2"(M) T-BAR ADAPTOR.(CR-V)	
1/4" HEX BITS (L:25MM)(CR-V)(ZINC PHOSPHATE FINISHED) W/2PC PE HOLDER:	6PC-STAR: T10, T15, T20, T25, T27, T30 4PC-SLOTTED: 3, 4, 5, 6 mm 3PC-PHILLIPS: PH1, PH2, PH3 7PC-HEX: 1.5, 2, 2.5, 3, 4, 5, 6 mm
COMB. WRENCHES:(CR-V)	6, 7, 8, 10, 11, 12, 13, 14, 15, 17, 19 mm
FLARE NUT WRENCHES:(CR-V)	8 x 10, 11 x 13, 12 x 14 mm
7" LOCKING PLIER.	
7" COMBINATION PLIER.	
6" LONG NOSE PLIER.	
300 GRAM HAMMER W/WOOD HANDLE.	
SCREWDRIVERS:(8660)	SLOTTED: 6.5 x 100, 8 x 150 mm PHILLIPS: PH1 x 75, PH2 x 38 (STUBBY), PH2 x 100 mm

Socket & Wrench

Impact Socket

Air Chisels

Automotive Tools

EUROPEAN STYLE SOCKET SET

88PC 1/4"DR. & 1/2"DR. TOOL KIT (MAT FINISHED)

1/4"

1/2"



Item No.	88PC-05A
2 COLOR BLOW CASE	L:452 xW:340 mm
WEIGHT	2145 (g)

CONTENT	
1/4"DR. 6PT SUPER LOCK SOCKETS:(CR-V)	4, 4.5, 5, 5.5, 6, 7, 8, 9, 10, 11, 12, 13 mm
1/2"DR. 6PT SUPER LOCK SOCKETS:(CR-V)	13, 14, 15, 16, 17, 18, 19, 20, 21, 22, 23, 24, 25, 26, 27, 30, 32 mm
1/4"DR. QUICK RELEASE RATCHET HANDLE.(72 TEETH)(CR-V)	
1/4"DR. 6" SPINNER HANDLE W/EXT.(CR-V)	
1/4"DR. EXTENSION BAR.(CR-V)	50 mm & 100 mm
1/4"DR. 1/4" COUPLER ADAPTOR.(CR-V)	
1/2"DR. QUICK RELEASE RATCHET HANDLE.(72 TEETH)(CR-V)	
1/2"DR. EXTENSION BAR.(CR-V)	125 mm
BIT SET W/PLASTIC CASE:	1/4" QUICK CHANGE CHUCK.(L:65 mm)
	1/4" BIT ADAPTOR.(L:25 mm)(CR-V)(ZINC PHOSPHATE FINISHED)
	1/4" BITS:(L:25 mm)(CR-V)(ZINC PHOSPHATE FINISHED)
	PHILLIPS: PH1, PH2, PH2, PH3
	POZI: PZ1, PZ2, PZ2, PZ3
	SLOTTED: 3, 4, 5, 6 mm
	HEX: 3, 4, 5, 6 mm
	STAR: T10, T15, T20, T25, T27, T30, T40
	STAR (TAMPERPROOF): T10H, T15H, T20H, T25H, T27H, T30H, T40H
	COMB. WRENCHES:(CR-V)
SCREWDRIVERS:(8660)	SLOTTED: 6.5 mmx100 mm, 8 mmx150 mm PHILLIPS: PH1x75 mm, PH2x100 mm
9-1/2" WATER PUMP PLIER.	
6" COMBINATION PLIER.	
SCREWDRIVER PROBE VOLTAGE TESTER. (TESTING RANGE: 110V-250V)(1800A)	
300 GRAM HAMMER W/WOOD HANDLE.	

102PC 1/4"DR. & 1/2"DR. TOOL KIT (MAT FINISHED)

1/4" 1/2"



Item No.	102PC-05A
2 COLOR BLOW CASE	L:383 x W:272 mm
WEIGHT	1876 (g)

CONTENT	
1/4"DR. 6PT SUPER LOCK SOCKETS:(CR-V)	4, 4.5, 5, 5.5, 6, 7, 8, 9, 10, 11, 12, 13 mm
1/2"DR. 6PT SUPER LOCK SOCKETS:(CR-V)	8, 10, 12, 13, 14, 15, 16, 17, 18, 19, 20, 21, 22, 23, 24,25, 26, 27, 30, 32 mm
1/4"DR. QUICK RELEASE RATCHET HANDLE. (72 TEETH)(CR-V)	
1/4"DR. UNIVERSAL JOINT.(CR-V)	
1/4"DR. 6" SPINNER HANDLE W/EXT.(CR-V)	
1/4"DR. EXTENSION BAR.(CR-V)	50 mm & 100 mm
1/4"DR. SLIDING T-BAR.(CR-V)	115 mm
1/4"DR. FLEXIBLE EXTENSION BAR.(CR-V)	150 mm
1/4"DR. 1/4" COUPLER ADAPTOR.(CR-V)	
1/2"DR. 1 (6PT) SPARK PLUG SOCKET.(CR-V)	6 mm & 21 mm
1/2"DR. QUICK RELEASE RATCHET HANDLE. (72 TEETH)(CR-V)	
1/2"DR. EXTENSION BAR.(CR-V)	125 mm
1/2"DR. 2-WAY WOBBLE EXTENSION BAR.(CR-V)	50 mm
1/2"DR. UNIVERSAL JOINT.(CR-V)	
1/2"DR. SLIDING T-BAR.(CR-V)	
1/2"DR. FLEXIBLE HANDLE.(CR-V)	430 mm
BIT SET W/PLASTIC CASE:	1/4" QUICK CHANGE CHUCK.(L:65 mm) 1/4" BIT ADAPTOR.(L:25mm)(CR-V) (ZINC PHOSPHATE FINISHED) 1/4" BITS:(L:25mm)(CR-V)(ZINC PHOSPHATE FINISHED) PHILLIPS: PH1, PH2, PH2, PH3 POZI: PZ1, PZ2, PZ2, PZ3 SLOTTED: 3, 4, 5, 6 mm HEX: 3, 4, 5, 6 mm STAR: T10, T15, T20, T25, T27, T30, T40 STAR (TAMPERPROOF): T10H, T15H, T20H, T25H, T27H, T30H, T40H
COMB. WRENCHES:(CR-V)	6, 7, 8, 9, 10, 11, 12, 13, 14, 15, 16, 17, 19, 22 mm
SCREWDRIVERS:(8660)	2PC-SLOTTED: 6.5 mmx100 mm, 8 mmx150 mm 2PC-PHILLIPS: PH1x75 mm, PH2x100 mm
9-1/2" WATER PUMP PLIER.	
6" COMBINATION PLIER.	
SCREWDRIVER PROBE VOLTAGE TESTER. (TESTING RANGE: 110V-250V)(1800A)	
500 GRAM HAMMER W/WOOD HANDLE.	

Socket & Wrench

Impact Socket

Air Chisels

Automotive Tools

EUROPEAN STYLE SOCKET SET

106PC 1/4"DR. & 1/2"DR. TOOL KIT (MAT FINISHED)

1/4"

1/2"



Item No.	106P-06A
2 COLOR BLOW CASE	L:552 xW:360 mm
WEIGHT	2230 (g)

CONTENT	
1/4"DR. 6PT SUPER LOCK SOCKETS:(CR-V)	4, 4.5, 5, 5.5, 6, 7, 8, 9, 10, 11, 12, 13 mm
1/2"DR. 6PT SUPER LOCK SOCKETS:(CR-V)	8, 10, 12, 13, 14, 15, 16, 17, 18, 19, 20, 21, 22, 23, 24,25, 26, 27, 30, 32 mm
1/4"DR. QUICK RELEASE RATCHET HANDLE. (72 TEETH)(CR-V)	
1/4"DR. UNIVERSAL JOINT.(CR-V)	
1/4"DR. 6" SPINNER HANDLE W/EXT.(CR-V)	
1/2"DR. EXTENSION BAR.(CR-V)	50 mm & 100 mm
1/4"DR. SLIDING T-BAR.(CR-V)	115 mm
1/4"DR. FLEXIBLE EXTENSION BAR.(CR-V)	150 mm
1/4"DR. 1/4" COUPLER ADAPTOR.(CR-V)	
1/2"DR. (6PT) SPARK PLUG SOCKET.(CR-V)	16 mm & 21 mm
1/2"DR. QUICK RELEASE RATCHET HANDLE. (72 TEETH)(CR-V)	
1/2"DR. EXTENSION BAR.(CR-V)	125 mm
1/2"DR. 2-WAY WOBBLE EXTENSION BAR. (CR-V)	50 mm
1/2"DR. UNIVERSAL JOINT.(CR-V)	
1/2"DR. SLIDING T-BAR.(CR-V)	
1/2"DR. FLEXIBLE HANDLE.(CR-V)	430 mm
BIT SET W/PLASTIC CASE:	1/4" QUICK CHANGE CHUCK.(L:65 mm)
	1/4" BIT ADAPTOR.(L:25 mm)(CR-V) (ZINC PHOSPHATE FINISHED)
	1/4" BITS:(L:25 mm)(CR-V) (ZINC PHOSPHATE FINISHED)
	PHILLIPS: PH1, PH2, PH2, PH3
	POZI: PZ1, PZ2, PZ2, PZ3
	SLOTTED: 3, 4, 5, 6 mm
	HEX: 3, 4, 5, 6 mm
	STAR: T10, T15, T20, T25, T27, T30, T40
	STAR: T10, T15, T20, T25, T27, T30, T40
	STAR (TAMPERPROOF): T10H, T15H, T20H, T25H, T27H, T30H, T40H
COMB. WRENCHES:(CR-V)	8, 10, 11, 12, 13, 14, 17, 19, 22 mm
10" ADJUSTABLE WRENCH.	
SCREWDRIVERS:(8660)	SLOTTED: 6.5 mmx38 mm(STUBBY), 6.5 mmx100 mm, 8 mmx150 mm PHILLIPS: PH1x75 mm, PH2x38 mm(STUBBY), PH2x100 mm
6" DIAGONAL PLIER.	
9-1/2" WATER PUMP PLIER.	
7" COMBINATION PLIER.	
6" LONG NOSE PLIER.	
CRIMPING TOOLS.	
SCREWDRIVER PROBE VOLTAGE TESTER. (TESTING RANGE: 110V-250V)(1800A)	
TERMINALS (40PCS.)	
UTILITY KNIFE.	
SCISSORS.	
500 GRAM HAMMER W/WOOD HANDLE.	

108PC 1/4"DR. & 1/2"DR. SOCKET SET (METRIC) (MAT FINISHED)

1/4"

1/2"



Item No.	108PC-06C
2 COLOR BLOW CASE	L:383 xW:272 mm
WEIGHT	2076 (g)

CONTENT	
1/4"DR. 6PT SUPER LOCK SOCKETS:(CR-V)	4, 4.5, 5, 5.5, 6, 7, 8, 9, 10, 11, 12, 13 mm
1/4"DR. 6PT DEEP SUPER LOCK SOCKETS:(CR-V)	6, 7, 8, 9, 10, 11, 12, 13 mm
1/2"DR. 6PT SUPER LOCK SOCKETS:(CR-V)	10, 11, 12, 13, 14, 15, 16, 17, 18, 19, 20, 21, 22, 24, 27, 30, 32 mm
1/2"DR. 6PT DEEP SUPER LOCK SOCKETS:(CR-V)	14, 15, 17, 19, 22 mm
1/4"DR. STAR SOCKETS:(CR-V)	E4, E5, E6, E7, E8
1/2"DR. STAR SOCKETS:(CR-V)	E10, E11, E12, E14, E16, E18, E20, E22
1/4"DR. QUICK RELEASE RATCHET HANDLE. (72 TEETH)(CR-V)	
1/4"DR. 6" SPINNER HANDLE W/EXT.(CR-V)	
1/4"DR. EXTENSION BAR.(CR-V)	50 mm & 100 mm
1/4"DR. SLIDING T-BAR.(CR-V)	
1/2"DR. (6PT) SPARK PLUG SOCKET.(CR-V)	16 mm & 21 mm
1/2"DR. QUICK RELEASE RATCHET HANDLE. (72 TEETH)(CR-V)	
1/2"DR. EXTENSION BAR.(CR-V)	125 mm & 250 mm
1/2"DR. UNIVERSAL JOINT.(CR-V)	
3/8"(F)x1/2"(M) T-BAR ADAPTOR.(CR-V)	
1/2"DR. 5/16" COUPLER ADAPTOR.(CR-V)	
1/4"DR. BIT SOCKETS:(BIT:S2, ZINC PHOSPHATE FINISHED; SOCKET:CR-V)	HEX: 3, 4, 5, 6 mm SLOTTED: 4, 5.5, 6.5 mm PHILLIPS: PH1, PH2 POZI: PZ1, PZ2 STAR: T8, T10, T15, T20, T25, T27, T30
5/16" BITS:(L:30mm)(CR-V)(ZINC PHOSPHATE FINISHED)	HEX: 8, 10, 12, 14 mm SLOTTED: 8, 10, 12 mm PHILLIPS: PH3, PH4 POZI: PZ3, PZ4 STAR: T40, T45, T50, T55, T60
HEX KEY WRENCHES (CR-V)	1.27, 1.5, 2, 2.5 mm

Socket & Wrench

Impact Socket

Air Chisels

Automotive Tools

EUROPEAN STYLE SOCKET SET

108PC 1/4"DR. & 1/2"DR. TOOL KIT (MAT FINISHED)

1/4"

1/2"



Item No.	108PC-07A
2 COLOR BLOW CASE	L:452 xW:340 mm
WEIGHT	3660 (g)

CONTENT	
1/4"DR. 6PT SUPER LOCK SOCKETS:(CR-V)	4, 4.5, 5, 5.5, 6, 7, 8, 9, 10, 11, 12, 13 mm
1/2"DR. 6PT SUPER LOCK SOCKETS:(CR-V)	8, 10, 12, 13, 14, 15, 16, 17, 18, 19, 20, 21, 22, 23, 24,25, 26, 27, 30, 32 mm
1/4"DR. QUICK RELEASE RATCHET HANDLE.(72 TEETH)(CR-V)	
1/4"DR. UNIVERSAL JOINT.(CR-V)	
1/4"DR. 6" SPINNER HANDLE W/EXT. (CR-V)	
1/4"DR. QUICK RELEASE RATCHET HANDLE.(72 TEETH)(CR-V)	
1/4"DR. 6" SPINNER HANDLE W/EXT. (CR-V)	
1/4"DR. EXTENSION BAR.(CR-V)	50 mm & 100 mm
1/4"DR. SLIDING T-BAR.(CR-V)	115 mm
1/4"DR. FLEXIBLE EXTENSION BAR. (CR-V)	150 mm
1/4"DR. 1/4" COUPLER ADAPTOR.(CR-V)	
1/2"DR. (6PT) SPARK PLUG SOCKET. (CR-V)	16 mm & 21 mm
1/2"DR. QUICK RELEASE RATCHET HANDLE.(72 TEETH)(CR-V)	
1/2"DR. EXTENSION BAR.(CR-V)	125 mm
1/2"DR. 2-WAY WOBBLE EXTENSION BAR.(CR-V)	50 mm
1/2"DR. UNIVERSAL JOINT.(CR-V)	
1/2"DR. SLIDING T-BAR.(CR-V)	
1/2"DR. FLEXIBLE HANDLE.(CR-V)	430 mm
BIT SET W/PLASTIC CASE:	1/4" QUICK CHANGE CHUCK.(L:65 mm) 1/4" BIT ADAPTOR.(L:25 mm)(CR-V)(ZINC PHOSPHATE FINISHED) 1/4" BITS:(L:25 mm)(CR-V)(ZINC PHOSPHATE FINISHED) PHILLIPS: PH1, PH2, PH2, PH3 POZI: PZ1, PZ2, PZ2, PZ3 SLOTTED: 3, 4, 5, 6 mm HEX: 3, 4, 5, 6 mm STAR: T10, T15, T20, T25, T27, T30, T40 STAR (TAMPERPROOF): T10H, T15H, T20H, T25H, T27H, T30H, T40H
HEX KEY WRENCHES (CR-V)	2.5, 3, 4, 5, 6, 7 mm
COMB. WRENCHES:(CR-V)	6, 7, 8, 9, 10, 11, 12, 13, 14, 15, 16, 17, 19, 22 mm
DOUBLE END FLEX WRENCHES:(CR-V)	10x11, 12x13, 14x15, 17x19 mm
500 GRAM HAMMER W/WOOD HANDLE.	
9-1/2" WATER PUMP PLIER.	
6" COMBINATION PLIER.	
SCREWDRIVER PROBE VOLTAGE TESTER. (TESTING RANGE: 110V-250V)(1800A)	

133PC 1/4"DR. & 1/2"DR. TOOL KIT (MAT FINISHED)

1/4" 1/2"



Item No.	133PC-03A
2 COLOR BLOW CASE	L:552 x W:360 mm
WEIGHT	2256 (g)

CONTENT	
1/4"DR. 6PT SUPER LOCK SOCKETS:(CR-V)	4, 4.5, 5, 5.5, 6, 7, 8, 9, 10, 11, 12, 13, 14 mm
1/4"DR. 6PT DEEP SUPER LOCK SOCKETS:(CR-V)	6, 7, 8, 9, 10, 11, 12, 13 mm
1/2"DR. 6PT SUPER LOCK SOCKETS:(CR-V)	10, 11, 12, 13, 14, 15, 16, 17, 18, 19, 20, 21, 22, 24, 27, 30, 32 mm
1/2"DR. 6PT DEEP SUPER LOCK SOCKETS (CR-V):	14, 15, 17, 19, 22 mm
1/4"DR. STAR SOCKETS (CR-V):	E4, E5, E6, E7, E8
1/2"DR. STAR SOCKETS (CR-V):	E10, E11, E12, E14, E16, E18, E20, E22
1/4"DR. QUICK RELEASE RATCHET HANDLE. (72 TEETH)(CR-V)	
1/4"DR. UNIVERSAL JOINT.(CR-V)	
1/4"DR. 6" SPINNER HANDLE W/EXT.(CR-V)	
1/4"DR. EXTENSION BAR.(CR-V)	50 mm & 100 mm
1/4"DR. SLIDING T-BAR.(CR-V)	115 mm
1/2"DR. (6PT) SPARK PLUG SOCKET.(CR-V)	16 mm & 21 mm
1/2"DR. QUICK RELEASE RATCHET HANDLE. (72 TEETH)(CR-V)	
1/2"DR. EXTENSION BAR.(CR-V)	125 mm & 250 mm
1/2"DR. UNIVERSAL JOINT.(CR-V)	
3/8"(F)x1/2"(M) T-BAR ADAPTOR.(CR-V)	
1/2"DR. 5/16" COUPLER ADAPTOR.(CR-V)	
1/4"DR. BIT SOCKETS:(BIT:S2, ZINC PHOSPHATE FINISHED; SOCKET:CR-V)	HEX: 3, 4, 5, 6 mm SLOTTED: 4, 5.5, 6.5 mm PHILLIPS: PH1, PH2 POZI: PZ1, PZ2 STAR: T8, T10, T15, T20, T25, T27, T30
5/16" BITS:(L:30mm)(CR-V)(ZINC PHOSPHATE FINISHED)	HEX: 8, 10, 12, 14 mm SLOTTED: 8, 10, 12 mm PHILLIPS: PH3, PH4 POZI: PZ3, PZ4 STAR: T40, T45, T50, T55, T60
HEX KEY WRENCHES (CR-V)	1.27, 1.5, 2, 2.5 mm
COMB. WRENCHES (CR-V)	8, 10, 11, 12, 13, 14, 17, 19, 22 mm
10" ADJUSTABLE WRENCH	
SCREWDRIVERS:(8660)	SLOTTED: 6.5 mmx38 mm(STUBBY), 6.5 mmx100 mm, 8 mmx150 mm PHILLIPS: PH1x75 mm, PH2x38 mm(STUBBY), PH2x100 mm
6" DIAGONAL CUTTING PLIER	
9-1/2" WATER PUMP PLIER	
7" COMBINATION PLIER.	
6" LONG NOSE PLIER	
CRIMPING TOOLS	
SCREWDRIVER PROBE VOLTAGE TESTER. (TESTING RANGE: 110V-250V)(1800A)	
TERMINALS (40PCS.)	
UTILITY KNIFE	
SCISSORS	

Socket & Wrench

Impact Socket

Air Chisels

Automotive Tools

BITS SOCKET

STAR BIT SOCKET

1/4"DR. STAR BIT SOCKET



1/4"

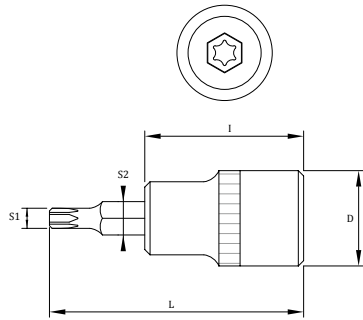

Item No.	S1	S2	L(mm)	I(mm)	D(mm)	G
CB2T6	T6	6.3	37	22	12	10
CB2T7	T7	6.3	37	22	12	10
CB2T8	T8	6.3	37	22	12	12
CB2T9	T9	6.3	37	22	12	12
CB2T10	T10	6.3	37	22	12	15
CB2T15	T15	6.3	37	22	12	16
CB2T20	T20	6.3	37	22	12	16
CB2T25	T25	6.3	37	22	12	16
CB2T27	T27	6.3	37	22	12	16
CB2T30	T30	6.3	37	22	12	16
CB2T40	T40	6.3	37	22	12	17

3/8"DR. STAR BIT SOCKET



3/8"

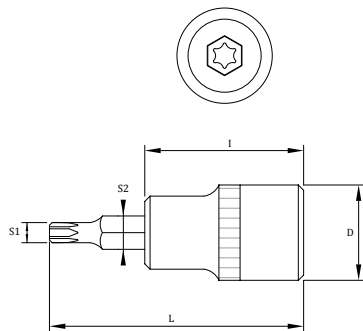

Item No.	S1	S2	L(mm)	I(mm)	D(mm)	G
CB3T8	T8	6.3	48	30	18	40
CB3T9	T9	6.3	48	30	18	40
CB3T10	T10	6.3	48	30	18	38
CB3T15	T15	6.3	48	30	18	38
CB3T20	T20	6.3	48	30	18	38
CB3T25	T25	6.3	48	30	18	38
CB3T27	T27	6.3	48	30	18	38
CB3T30	T30	6.3	48	30	18	39
CB3T40	T40	8.0	48	30	18	45
CB3T45	T45	8.0	48	30	18	45
CB3T47	T47	8.0	48	30	18	46
CB3T50	T50	8.0	48	30	18	46
CB3T55	T55	10.0	48	30	20	62
CB3T60	T60	10.0	48	30	20	64

1/2"DR. STAR BIT SOCKET



1/2"

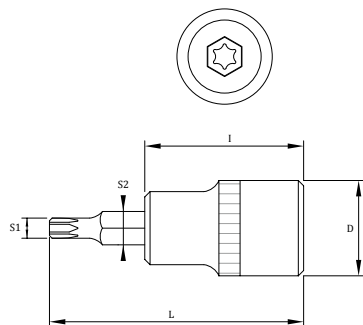

Item No.	S1	S2	L(mm)	I(mm)	D(mm)	G
CB4T20	T20	6.3	55	38	22	58
CB4T25	T25	6.3	55	38	22	58
CB4T27	T27	6.3	55	38	22	59
CB4T30	T30	6.3	55	38	22	59
CB4T40	T40	8.0	55	38	22	63
CB4T45	T45	8.0	55	38	22	64
CB4T47	T47	8.0	55	38	22	70
CB4T50	T50	8.0	55	38	22	65
CB4T55	T55	10.0	55	38	22	74
CB4T60	T60	12.0	55	38	24	100
CB4T70	T70	14.0	55	38	24	120
CB4T80	T80	14.0	55	38	24	180

TAMPERPROOF BIT SOCKET

1/4"DR. STAR TAMPERPROOF BIT SOCKET

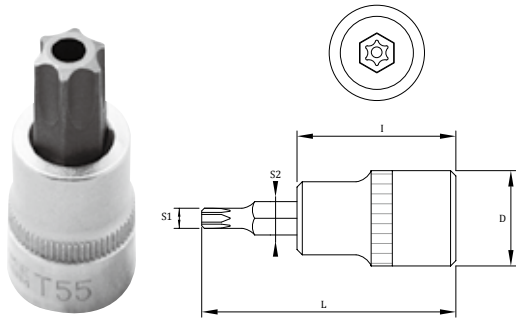

Item No.	S1	S2	L(mm)	I(mm)	D(mm)	G
CB2T6H	T6H	6.3	37	22	12	15
CB2T7H	T7H	6.3	37	22	12	15
CB2T8H	T8H	6.3	37	22	12	15
CB2T9H	T9H	6.3	37	22	12	15
CB2T10H	T10H	6.3	37	22	12	15
CB2T15H	T15H	6.3	37	22	12	16
CB2T20H	T20H	6.3	37	22	12	16
CB2T25H	T25H	6.3	37	22	12	16
CB2T27H	T27H	6.3	37	22	12	16
CB2T30H	T30H	6.3	37	22	12	16
CB2T40H	T40H	6.3	37	22	12	17

3/8"DR. STAR TAMPERPROOF BIT SOCKET

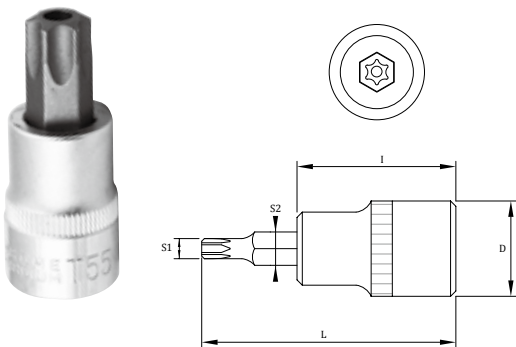

Item No.	S1	S2	L(mm)	I(mm)	D(mm)	G
CB3T8H	T8H	6.3	48	30	18	40
CB3T9H	T9H	6.3	48	30	18	40
CB3T10H	T10H	6.3	48	30	18	38
CB3T15H	T15H	6.3	48	30	18	38
CB3T20H	T20H	6.3	48	30	18	38
CB3T25H	T25H	6.3	48	30	18	38
CB3T27H	T27H	6.3	48	30	18	38
CB3T30H	T30H	6.3	48	30	18	39
CB3T40H	T40H	8	48	30	18	45
CB3T45H	T45H	8	48	30	18	45
CB3T47H	T47H	8	48	30	18	46
CB3T50H	T50H	8	48	30	18	46
CB3T55H	T55H	10	48	30	20	62
CB3T60H	T60H	10	48	30	20	64

1/2"DR. STAR TAMPERPROOF BIT SOCKET

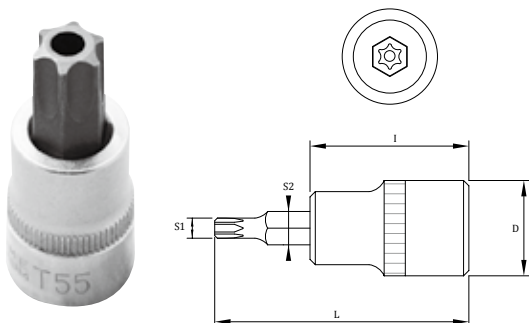

Item No.	S1	S2	L(mm)	I(mm)	D(mm)	G
CB4T20H	T20H	6.3	55	38	22	58
CB4T25H	T25H	6.3	55	38	22	58
CB4T27H	T27H	6.3	55	38	22	59
CB4T30H	T30H	6.3	55	38	22	59
CB4T40H	T40H	8	55	38	22	63
CB4T45H	T45H	8	55	38	22	64
CB4T47H	T47H	8	55	38	22	70
CB4T50H	T50H	8	55	38	22	65
CB4T55H	T55H	10	55	38	22	74
CB4T60H	T60H	12	55	38	24	100
CB4T70H	T70H	14	55	38	24	120
CB4T80H	T80H	14	55	38	24	180

Socket & Wrench

Impact Socket

Air Chisels

Automotive Tools

BITS SOCKET

SLOTTED BIT SOCKET

1/4"DR. SLOTTED BIT SOCKET



Item No.	S1	S2	L(mm)	l(mm)	D(mm)	G
CB2SL3	3	6.3	37	22	12	12
CB2SL4	4	6.3	37	22	12	12
CB2SL5	5	6.3	37	22	12	12
CB2SL6	6	6.3	37	22	12	12
CB2SL7	7	6.3	37	22	12	12
CB2SL8	8	6.3	37	22	12	12

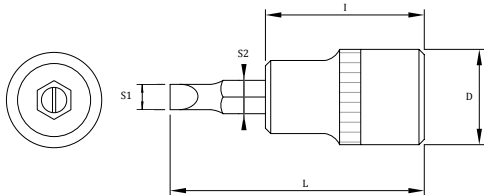

3/8"DR. SLOTTED BIT SOCKET



Item No.	S1	S2	L(mm)	l(mm)	D(mm)	G
CB3SL3	3	6.3	48	30	18	50
CB3SL4	4	6.3	48	30	18	50
CB3SL5	5	6.3	48	30	18	50
CB3SL6	6	6.3	48	30	18	50
CB3SL7	7	6.3	48	30	18	50
CB3SL8	8	8	48	30	18	50
CB3SL10	10	10	48	30	20	50

1/2"DR. SLOTTED BIT SOCKET



Item No.	S1	S2	L(mm)	l(mm)	D(mm)	G
CB4SL4	4	10	55	38	22	50
CB4SL55	5.5	10	55	38	22	50
CB4SL6	6	10	55	38	22	50
CB4SL8	8	10	55	38	22	70
CB4SL10	10	10	55	38	22	70
CB4SL12	12	10	55	38	22	92
CB4SL14	14	10	55	38	22	112
CB4SL16	16	10	55	38	22	112

PHILLIPS BIT SOCKET

1/4"DR. PHILLIPS BIT SOCKET



Item No.	S1	S2	L(mm)	l(mm)	D(mm)	G
CB2PH0	PH0	6.3	37	22	12	19
CB2PH1	PH1	6.3	37	22	12	20
CB2PH2	PH2	6.3	37	22	12	20
CB2PH3	PH3	6.3	37	22	12	20

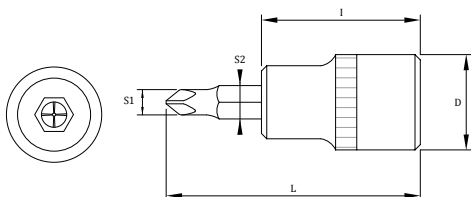

3/8"DR. PHILLIPS BIT SOCKET



Item No.	S1	S2	L(mm)	l(mm)	D(mm)	G
CB3PH1	PH1	6.3	48	30	18	50
CB3PH2	PH2	6.3	48	30	18	50
CB3PH3	PH3	8	48	30	18	50
CB3PH4	PH4	8	48	30	18	50

1/2"DR. PHILLIPS BIT SOCKET



Item No.	S1	S2	L(mm)	l(mm)	D(mm)	G
CB4PH2	PH2	6.3	55	39.5	22	65
CB4PH3	PH3	8	55	39.5	22	65
CB4PH4	PH4	8	55	39.5	22	70

POZI BIT SOCKET

1/4"DR. POZI BIT SOCKET



Item No.	S1	S2	L(mm)	l(mm)	D(mm)	G
CB2PZ0	PZ0	6.3	37	22	12	20
CB2PZ1	PZ1	6.3	37	22	12	20
CB2PZ2	PZ2	6.3	37	22	12	20
CB2PZ3	PZ3	6.3	37	22	12	20

3/8"DR. POZI BIT SOCKET



Item No.	S1	S2	L(mm)	l(mm)	D(mm)	G
CB3PZ1	PZ1	6.3	48	30	18	50
CB3PZ2	PZ2	6.3	48	30	18	50
CB3PZ3	PZ3	8.0	48	30	18	52
CB3PZ4	PZ4	8.0	48	30	18	52

1/2"DR. POZI BIT SOCKET



Item No.	S1	S2	L(mm)	l(mm)	D(mm)	G
CB4PZ1	PZ1	6.3	55	38	22	65
CB4PZ2	PZ2	6.3	55	38	22	65
CB4PZ3	PZ3	6.3	55	38	22	65
CB4PZ4	PZ4	8.0	55	38	22	70

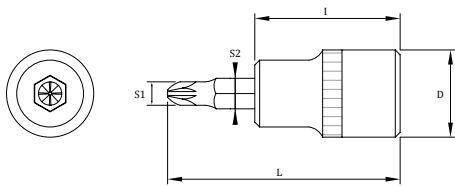

HEX BIT SOCKET

1/4"DR. HEX BIT SOCKET



Item No.	S1	S2	L(mm)	l(mm)	D(mm)	G
CB2H3	H3	6.3	37	22	12	16
CB2H4	H4	6.3	37	22	12	16
CB2H5	H5	6.3	37	22	12	17
CB2H6	H6	6.3	37	22	12	17
CB2H7	H7	6.3	37	22	12	18
CB2H8	H8	6.3	37	22	12	20

3/8"DR. HEX BIT SOCKET



Item No.	S1	S2	L(mm)	l(mm)	D(mm)	G
CB3H3	H3	6.3	48	30	18	38
CB3H4	H4	6.3	48	30	18	38
CB3H5	H5	6.3	48	30	18	39
CB3H6	H6	6.3	48	30	18	40
CB3H7	H7	8.0	48	30	18	45
CB3H8	H8	8.0	48	30	18	46
CB3H10	H10	10.0	48	30	20	63
CB3H12	H12	10.0	48	30	20	65

1/2"DR. HEX BIT SOCKET



Item No.	S1	S2	L(mm)	l(mm)	D(mm)	G
CB4H4	H4	6.3	55	38	22	58
CB4H5	H5	6.3	55	38	22	59
CB4H6	H6	6.3	55	38	22	60
CB4H7	H7	8.0	55	38	22	64
CB4H8	H8	8.0	55	38	22	65
CB4H10	H10	10.0	55	38	22	75
CB4H12	H12	12.0	55	38	24	102
CB4H14	H14	14.0	55	38	24	112
CB4H17	H17	14.0	55	38	24	115
CB4H19	H19	14.0	55	38	24	115

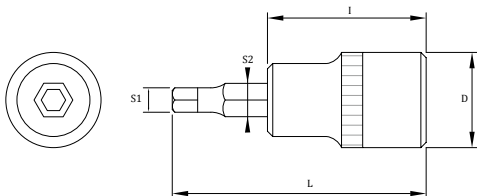

Socket & Wrench

Impact Socket

Air Chisels

Automotive Tools

BITS SOCKET

TRIPLE SQUARE BIT SOCKET

1/4"DR. TRIPLE SQUARE BIT SOCKET

12

1/4"



Item No.	S1	S2	L(mm)	l(mm)	D(mm)	G
CB2M4	M4	6.3	37	22	12	10
CB2M5	M5	6.3	37	22	12	10
CB2M6	M6	6.3	37	22	12	10

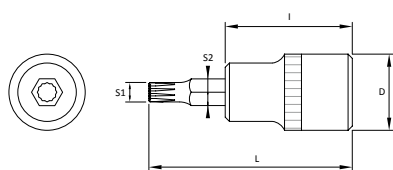

3/8"DR. TRIPLE SQUARE BIT SOCKET

12

3/8"

Item No.	S1	S2	L(mm)	l(mm)	D(mm)	G
CB3M4	M4	6.3	48	30	18	20
CB3M5	M5	6.3	48	30	18	20
CB3M6	M6	6.3	48	30	18	20
CB3M8	M8	8	48	30	18	20
CB3M10	M10	10	48	30	20	20
CB3M12	M12	10	48	30	20	25
CB3M14	M14	10	48	30	20	30

1/2"DR. TRIPLE SQUARE BIT SOCKET

12

1/2"

Item No.	S1	S2	L(mm)	l(mm)	D(mm)	G
CB4M4	M4	6.3	55	38	22	50
CB4M5	M5	6.3	55	38	22	59
CB4M6	M6	6.3	55	38	22	58
CB4M8	M8	8.0	55	38	22	64
CB4M10	M10	10.0	55	38	22	73
CB4M12	M12	12.0	55	38	24	98
CB4M14	M14	14.0	55	38	24	100
CB4M16	M16	14.0	55	38	24	100

3/8"DR. RIBE BIT SOCKET



3/8"



Item No.	S1	S2	L(mm)	l(mm)	D(mm)	G
CB3R4	4	6.3	48	30	18	20
CB3R5	5	6.3	48	30	18	20
CB3R6	6	6.3	48	30	18	20
CB3R7	7	8.0	48	30	18	20
CB3R8	8	8.0	48	30	18	20
CB3R9	9	10.0	48	30	20	20
CB3R10	10	10.0	48	30	20	20
CB3R11	11	10.0	48	30	20	25
CB3R12	12	10.0	48	30	20	25
CB3R13	13	10.0	48	30	20	30
CB3R14	14	10.0	48	30	20	30

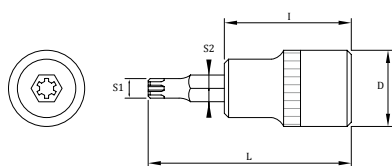

5 POINT TAMPERPROOF BIT SOCKET

1/2"DR. 5 POINT TAMPERPROOF STAR BIT SOCKET



Item No.	S1	S2	L(mm)	l(mm)	D(mm)	G
CB4TS20H	TSH20	6.3	55	38	22	55
CB4TS25H	TSH25	6.3	55	38	22	57
CB4TS27H	TSH27	6.3	55	38	22	57
CB4TS30H	TSH30	6.3	55	38	22	58
CB4TS40H	TSH40	8.0	55	38	22	63
CB4TS45H	TSH45	8.0	55	38	22	64
CB4TS50H	TSH50	8.0	55	38	22	66
CB4TS55H	TSH55	10.0	55	38	22	74
CB4TS60H	TSH60	10.0	55	38	22	100

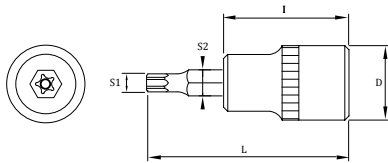

Socket & Wrench

Impact Socket

Air Chisels

Automotive Tools

5 POINT STAR BIT SOCKET

1/2"DR. 5 POINT STAR BIT SOCKET



Item No.	S1	S2	L(mm)	l(mm)	D(mm)	G
CB4TS20	TS20	6.3	55	38	22	55
CB4TS25	TS25	6.3	55	38	22	57
CB4TS27	TS27	6.3	55	38	22	57
CB4TS30	TS30	6.3	55	38	22	58
CB4TS40	TS40	8	55	38	22	63
CB4TS45	TS45	8	55	38	22	64
CB4TS50	TS50	8	55	38	22	66
CB4TS55	TS55	10	55	38	22	74
CB4TS60	TS60	10	55	38	24	100

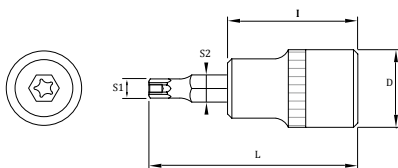

BITS SOCKET

HEX BIT SOCKET SET

10PC 3/8" & 1/2"DR. HEX BIT SOCKET SET

6

3/8"

1/2"



Item No.	10PC-SM1-mm
DOUBLE BLISTER	L:250 x W:120 mm
WEIGHT	2840 (g)

CONTENT	
3/8"DR. HEX BIT SOCKET	3, 4, 5, 6, 7, 8, 10
1/2"DR. HEX BIT SOCKET	12, 14, 16

10PC 3/8" & 1/2"DR. HEX BIT SOCKET SET

6

3/8"

1/2"



Item No.	10PC-SM1-SAE
DOUBLE BLISTER	L:300 x W:125 mm
WEIGHT	2840 (g)

CONTENT	
3/8"DR. HEX BIT SOCKET	1/8", 5/32", 3/16", 7/32", 1/4", 5/16", 3/8"
1/2"DR. HEX BIT SOCKET	1/2", 9/16, 5/8"

STAR BIT SOCKET SET

9PC 1/2" DR. 5 POINT STAR TAMPERPROOF BIT SOCKET SET



Item No.	9PC-21B
BLOW CASE	L:200 x W:92 x H:42 mm
WEIGHT	667 (g)

CONTENT	
1/2"DR. 5 POINT STAR BIT SOCKET	TSH20, TSH25, TSH27, TSH30, TSH40, TSH45, TSH50, TSH55, TSH60

Socket & Wrench

Impact Socket

Air Chisels

11PC 1/4" & 3/8" DR. STAR BIT SOCKET SET



Item No.	11PC-15C
DOUBLE BLISTER	L:290 x W:110 mm
WEIGHT	790 (g)

CONTENT	
1/4"DR. STAR BIT SOCKET	T10, T15, T20, T25, T27, T30
3/8"DR. STAR BIT SOCKET	T40, T45, T47, T50, T55

Automotive Tools

10PC 1/4" & 3/8" DR. STAR TAMPERPROOF BIT SOCKET SET



Item No.	10PC-06
DOUBLE BLISTER	L:300 x W:125 mm
WEIGHT	1440 (g)

CONTENT	
1/4"DR.STAR TAMPERPROOF BIT SOCKET	T10H, T15H, T20H, T25H, T27H, T30H
3/8"DR. STAR TAMPERPROOF BIT SOCKET	T40H, T45H, T50H, T55H

BOX WRENCH

BOX WRENCH

BOX WRENCH WITH GROOVE

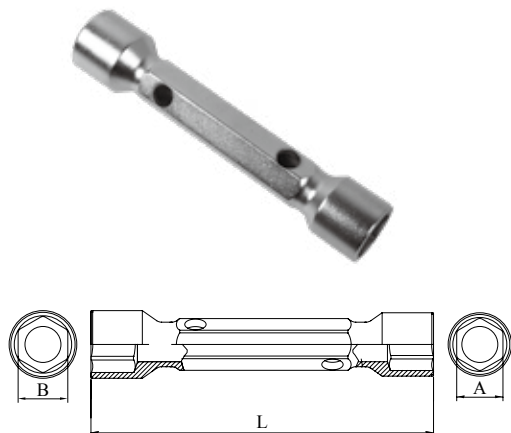

Item No.	Size(AxB)	A(mm)	B(mm)	L(mm)
KDTHFA0607	6x7	6	7	110
KDTHFA0809	8x9	8	9	120
KDTHFA1011	10x11	10	11	130
KDTHFA1213	12x13	12	13	140
KDTHFA1415	14x15	14	15	150
KDTHFA1617	16x17	16	17	160
KDTHFA1819	18x19	18	19	170
KDTHFA2022	20x22	20	22	180
KDTHFA2123	21x23	21	23	185
KDTHFA2426	24x26	24	26	190
KDTHFA2528	25x28	25	28	195
KDTHFA2729	27x29	27	29	200
KDTHFA3032	30x32	30	32	200
KDTHFA3641	36x41	36	41	240

ANGLE BOX WRENCH WITH GROOVE

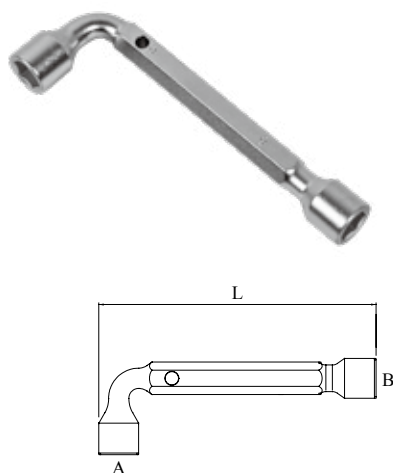

Item No.	Size(AxB)	A(mm)	B(mm)	L(mm)
KDTLHUS055	5.5	5.5	5.5	87
KDTLHUS06	6	6	6	95
KDTLHUS07	7	7	7	97
KDTLHUS08	8	8	8	106
KDTLHUS09	9	9	9	113
KDTLHUS10	10	10	10	122
KDTLHUS11	11	11	11	132
KDTLHUS12	12	12	12	137
KDTLHUS13	13	13	13	146
KDTLHUS14	14	14	14	154
KDTLHUS15	15	15	15	159
KDTLHUS16	16	16	16	168
KDTLHUS17	17	17	17	170
KDTLHUS18	18	18	18	176
KDTLHUS19	19	19	19	185
KDTLHUS22	22	22	22	199
KDTLHUS24	24	24	24	209

TOMMY BAR



Item No.	Drawing	L
160A-220	A	220
160A-300	B	300
160A-350	C	350

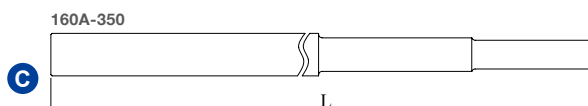
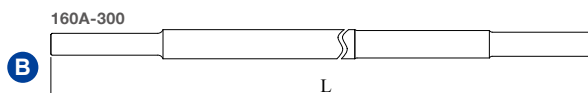
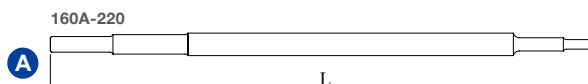

Different Lengths for Different Needs.

From 37 mm to 152 mm
New Set for The Professional Tool Market.



Socket & Wrench

Impact Socket

Air Chisels

Automotive Tools

ABOUT TIEN-I



Company Name	Tien-i Industrial Corporation Limited
Established Year	2004
Business Registration Code	80646988
Employee	100
Sales Representative	Candice Jiang Ginny Lien Ring Ku Tannis Huang
Language	English, Mandarin
Country	Taiwan R.O.C.
Address	No. 43, Gongyequ 23rd Rd., Nantun Dist., Taichung City 40850, Taiwan (R.O.C.)
Factory Size	9000 Square Meter

About Tien-i

In 2004, Larry Lee and Shaio-Pao partnered with 10 industry leaders to found Tien-I, a socket manufacturing firm based in Taichung, Taiwan. Having established a reputation for creating quality tools across the last 15 years, the company has continued to expand its product range and to nurture customer relationships. Presently, Tien-I supplies its global clients with over ten thousand items, including socket tool kits,

impact sockets, air chisels, tube tools, and automotive tools.

Clients include leading German and American tool brands in the aviation, automobile and solar industries, as well as Japanese machine companies. We consider ourselves more than a supplier—we would like to be your partner in creating an enduring brand.





WHY TIEN-I

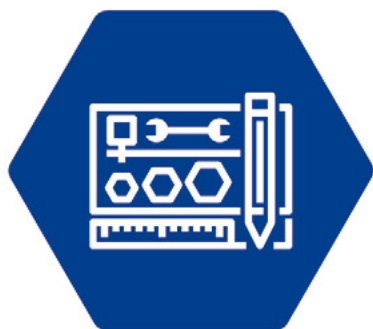

CUSTOM SOCKET SET

Tien-i Taiwan Excellence Award-winning Team Provide a Variety of Customized Tool Sizes.



FOR PRO BRANDS

Supply to Fortune 500 Companies. Top Tool Brands Assigned for the Aviation, High-tech Machine Company.



TRANSPARENT FACTORY

With Secure Score from D&B Financial Report, Pass Intertek Factory Audit Pass, and Provide Trackable Quality Report.

From Concept to Component

Tien-i's R&D engineering team specializes in manufacturing precision metal parts, especially cold forged and tube components. From the beginning of the design phase, the engineers work with our clients to transform the product concept into a manufacturable component.

Our engineers have the expertise to improve quality, accelerate time to market, and reduce waste. We offer consulting assistance to minimize cost without compromising on performance.



Tailored for Your Market

Which tool kit is more successful in your market—the 446pc Master Tools Kit or the 36pc Professional Socket Set?

Decades of experience have shown us that the determining factors are: relevance of contents; and appeal and durability of packaging. With over 20,000 tools in our warehouse, Tien-i wholly customizes the contents of your tool sets. Based on the demands of your local market preference, our team will handpick the ideal selection of tools and packaging.

Exclusive molds are available on request.



100% Made in Taiwan for Pro Brands

In order to swiftly provide the products to companies all over the world, we are continuously increasing our manufacturing capacity in Taiwan. We have heavily invested in the machines

and molds to keep optimizing our production process. Managing our supply chain management via IT and ERP systems enables us to provide our global clients with over 20,000 SKU daily.

Our Major Processes Include:

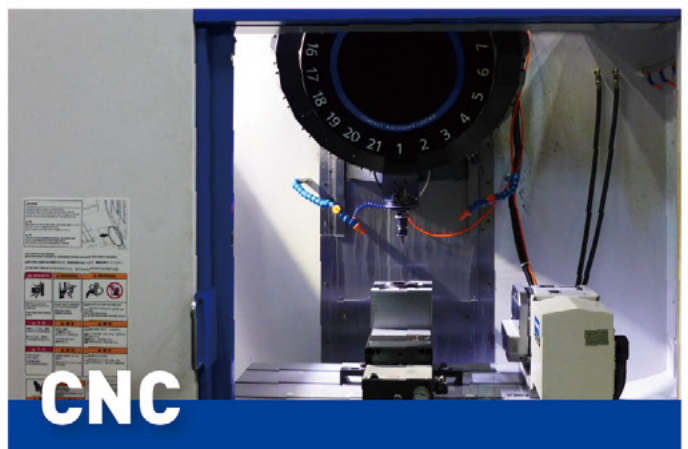
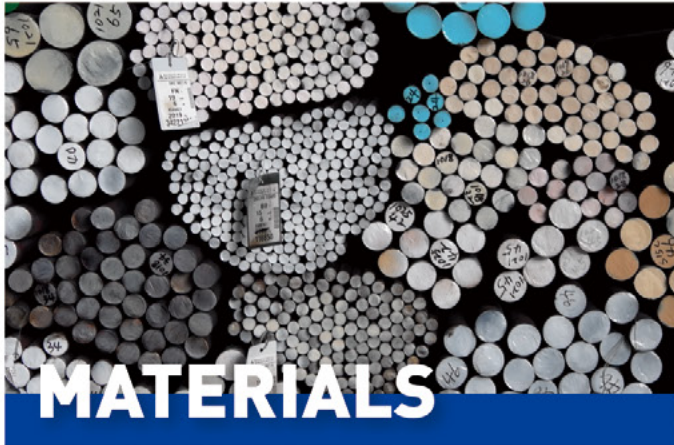



QUALITY AND SAFETY ASSURANCE

To uphold the company's core values of integrity and reliability, Tien-i strives always to provide its clientele with tools of unsurpassed quality and meeting stringent safety standards. We have ISO 9001 and ROHS certification, and

our factories have passed the Intertek Audit. Each member of our quality control team has undergone SGS training to ensure that every Tien-i product satisfies DIN, ISO and ANSI/ASTM international standards.

Our Certificate



ISO
9001:2015



Supplier Qualification
Program



Made in
Taiwan



Taiwan
Excellence

Our Lab Equipment

1. Salt Spary Machine
Test for Thickness of Plating
2. Torsion Test Machine
Life-test & Ultimate Torque
3. Hardness Machines
Test Material's Hardness
4. Optical Projector
Measure Precise Dimension in μm Level
5. Measure Specification
6. Complete and Sophisticated Gauges
7. Standard, Key to Quality

